

# Kettenräder

---

Kettenräder Simplex

Kettenräder Duplex

Kettenräder Triplex

Kettenräder Simplex gehärtet

Kettenräder Simplex rostfrei

Kettenräder Simplex für Klemmbuchsen

Kettenräder Duplex für Klemmbuchsen

Sonderanfertigungen nach Zeichnung sowie  
Standardteile einbaufertig bearbeitet,  
auf Wunsch mit Wärme- und/oder Oberflächenbehandlung

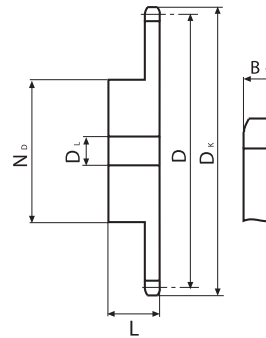

## Kettenräder – simplex

G&G-Best.-Nr.	Zz	D <sub>K</sub>	D	L	N <sub>b</sub>	D <sub>L</sub>
501-061-0008	8	18.0	15.67	10	9.8	5
501-061-0009	9	19.9	17.54	10	11.5	5
501-061-0010	10	21.7	19.42	10	13	6
501-061-0011	11	23.6	21.30	10	14	6
501-061-0012	12	25.4	23.18	10	16	6
501-061-0013	13	27.3	25.05	10	18	8
501-061-0014	14	29.2	26.96	10	20	8
501-061-0015	15	31.1	28.86	10	20	8
501-061-0016	16	33.0	30.76	13	20	8
501-061-0017	17	35.0	32.65	13	20	8
501-061-0018	18	36.9	34.55	13	20	8
501-061-0019	19	38.8	36.44	13	20	8
501-061-0020	20	40.7	38.34	13	20	8
501-061-0021	21	42.6	40.25	13	25	8
501-061-0022	22	44.5	42.16	13	25	8
501-061-0023	23	46.4	44.06	13	25	8
501-061-0024	24	48.3	45.96	13	25	8
501-061-0025	25	50.2	47.87	13	25	8

### Rollenkette DIN 8187

04 B-1  
6,0 x 2,8mm

Teilung 6,0mm  
Innere Breite 2,8mm  
Rollen ø 4,0mm

### Kettenrad DIN 8196

Zahnbreite B1 2,6mm  
Werkstoff: C45

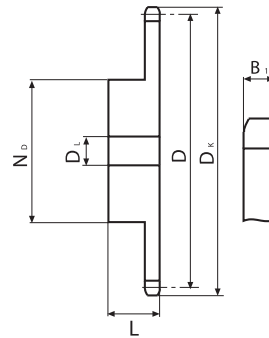

## Kettenräder – simplex

G&G-Best.-Nr.	Zz	D <sub>K</sub>	D	L	N <sub>b</sub>	D <sub>L</sub>
501-061-0026	26	52.1	49.77	15	30	8
501-061-0027	27	54.0	51.67	15	30	8
501-061-0028	28	55.9	53.58	15	30	8
501-061-0029	29	57.8	55.50	15	30	8
501-061-0030	30	59.8	57.42	15	30	8
501-061-0031	31	61.7	59.31	15	30	8
501-061-0032	32	63.6	61.21	15	30	8
501-061-0033	33	65.5	63.11	15	30	8
501-061-0034	34	67.4	65.02	15	30	8
501-061-0035	35	69.3	66.93	15	30	8
501-061-0036	36	71.2	68.84	15	30	8
501-061-0037	37	73.1	70.75	15	30	8
501-061-0038	38	75.0	72.66	15	30	8
501-061-0039	39	76.9	74.56	15	30	8
501-061-0040	40	78.9	76.47	15	30	8

### Rollenkette DIN 8187

04 B-1  
6,0 x 2,8mm

Teilung 6,0mm  
Innere Breite 2,8mm  
Rollen ø 4,0mm

### Kettenrad DIN 8196

Zahnbreite B1 2,6mm  
Werkstoff: C45

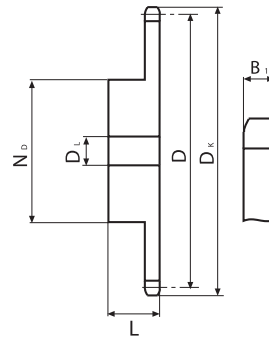

## Kettenräder – simplex

G&G-Best.-Nr.	Zz	D <sub>K</sub>	D	L	N <sub>b</sub>	D <sub>L</sub>
501-081-0008	8	24.0	20.90	12	13	6
501-081-0009	9	26.6	23.39	12	15	6
501-081-0010	10	29.2	25.89	12	17	8
501-081-0011	11	31.7	28.39	13	18	8
501-081-0012	12	34.2	30.91	13	20	8
501-081-0013	13	36.7	33.42	13	23	8
501-081-0014	14	39.2	35.95	13	25	8
501-081-0015	15	41.7	38.48	13	28	8
501-081-0016	16	44.3	41.01	14	30	8
501-081-0017	17	46.8	43.53	14	30	8
501-081-0018	18	49.3	46.07	14	30	8
501-081-0019	19	51.9	48.61	14	30	8
501-081-0020	20	54.4	51.14	14	30	8
501-081-0021	21	57.0	53.67	14	35	8
501-081-0022	22	59.5	56.21	14	35	8
501-081-0023	23	62.0	58.75	14	35	8
501-081-0024	24	64.6	61.29	14	35	8
501-081-0025	25	67.5	63.83	14	35	8

### Rollenkette DIN 8187

05 B-1  
8,0 x 3,0mm

Teilung 8,0mm  
Innere Breite 3,0mm  
Rollen ø 5,0mm

### Kettenrad DIN 8196

Zahnbreite B1 2,8mm  
Werkstoff: C45

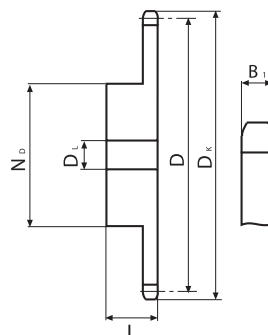

## Kettenräder – simplex

G&G-Best.-Nr.	Zz	D <sub>K</sub>	D	L	N <sub>b</sub>	D <sub>L</sub>
501-081-0026	26	69.5	66.37	16	40	10
501-081-0027	27	72.2	68.91	16	40	10
501-081-0028	28	74.8	71.45	16	40	10
501-081-0029	29	77.3	73.99	16	40	10
501-081-0030	30	79.8	76.53	16	40	10
501-081-0031	31	82.4	79.08	16	40	10
501-081-0032	32	84.9	81.61	16	40	10
501-081-0033	33	87.5	84.16	16	40	10
501-081-0034	34	90.0	86.70	16	40	10
501-081-0035	35	92.5	89.24	16	40	10
501-081-0036	36	95.0	91.79	16	40	10
501-081-0037	37	97.6	94.33	16	40	10
501-081-0038	38	100.2	96.88	16	40	10
501-081-0039	39	102.7	99.42	16	40	10
501-081-0040	40	105.2	101.97	16	40	10

### Rollenkette DIN 8187

05 B-1  
8,0 x 3,0mm

Teilung 8,0mm  
Innere Breite 3,0mm  
Rollen ø 5,0mm

### Kettenrad DIN 8196

Zahnbreite B1 2,8mm  
Werkstoff: C45

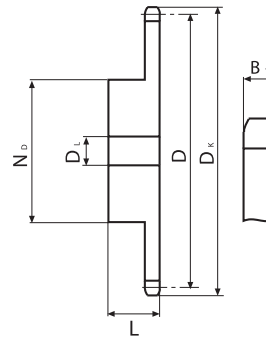

## Kettenräder – simplex

G&G-Best.-Nr.	Zz	D <sub>K</sub>	D	L	N <sub>b</sub>	D <sub>L</sub>
501-101-0008	8	28.0	24.89	22	15	8
501-101-0009	9	31.0	27.85	22	18	8
501-101-0010	10	34.0	30.82	22	20	8
501-101-0011	11	37.0	33.80	25	22	8
501-101-0012	12	40.0	36.80	25	25	8
501-101-0013	13	43.0	39.80	25	28	10
501-101-0014	14	46.3	42.80	25	31	10
501-101-0015	15	49.3	45.81	25	34	10
501-101-0016	16	52.3	48.82	28	37	10
501-101-0017	17	55.3	51.83	28	40	10
501-101-0018	18	58.3	54.85	28	43	10
501-101-0019	19	61.3	57.87	28	45	10
501-101-0020	20	64.3	60.89	28	46	10
501-101-0021	21	68.0	63.91	28	48	12
501-101-0022	22	71.0	66.93	28	50	12
501-101-0023	23	73.5	69.95	28	52	12
501-101-0024	24	77.0	72.97	28	54	12

### Rollenkette DIN 8187

06 B-1  
3/8 x 7/32"  
9,525 x 5,72mm

Teilung 9,525mm  
Innere Breite 5,72mm  
Rollen ø 6,35mm

### Kettenrad DIN 8196

Zahnbreite B1 5,3mm  
Werkstoff: C45

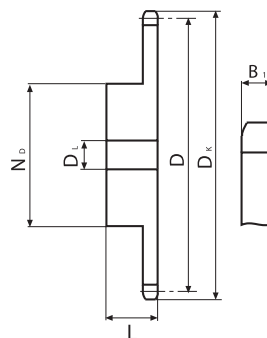

## Kettenräder – simplex

G&G-Best.-Nr.	Zz	D <sub>K</sub>	D	L	N <sub>b</sub>	D <sub>L</sub>
501-101-0025	25	80.0	76.00	28	57	12
501-101-0026	26	83.0	79.02	28	60	12
501-101-0027	27	86.0	82.04	28	60	12
501-101-0028	28	89.0	85.07	28	60	12
501-101-0029	29	92.0	88.09	28	60	12
501-101-0030	30	94.7	91.12	28	60	12
501-101-0031	31	98.3	94.15	30	65	14
501-101-0032	32	101.3	97.17	30	65	14
501-101-0033	33	104.3	100.20	30	65	14
501-101-0034	34	107.3	103.23	30	65	14
501-101-0035	35	110.4	106.26	30	65	14
501-101-0036	36	113.4	109.29	30	70	16
501-101-0037	37	116.4	112.32	30	70	16
501-101-0038	38	119.5	115.34	30	70	16
501-101-0039	39	122.5	118.37	30	70	16
501-101-0040	40	125.5	121.40	30	70	16

### Rollenkette DIN 8187

06 B-1  
3/8 x 7/32"  
9,525 x 5,72mm

Teilung 9,525mm  
Innere Breite 5,72mm  
Rollen ø 6,35mm

### Kettenrad DIN 8196

Zahnbreite B1 5,3mm  
Werkstoff: C45

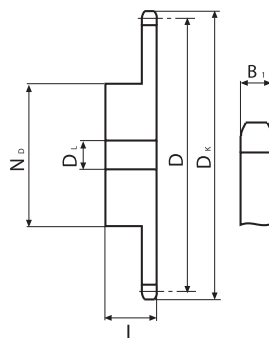

## Kettenräder – simplex

G&G-Best.-Nr.	Zz	D <sub>K</sub>	D	L	N <sub>b</sub>	D <sub>L</sub>
501-211-0008	8	37.2	33.18	14	21	8
501-211-0009	9	41.5	37.13	14	25	8
501-211-0010	10	46.2	41.10	14	28	8
501-211-0011	11	49.6	45.07	16	31	8
501-211-0012	12	53.9	49.07	16	35	8
501-211-0013	13	58.4	53.06	16	39	8
501-211-0014	14	62.8	57.07	16	43	8
501-211-0015	15	66.8	61.09	16	47	8
501-211-0016	16	70.9	65.10	18	50	10
501-211-0017	17	74.9	69.11	18	50	10
501-211-0018	18	78.9	73.14	18	50	10
501-211-0019	19	82.9	77.16	18	50	10
501-211-0020	20	86.9	81.19	18	50	10
501-211-0021	21	91.0	85.22	20	60	12
501-211-0022	22	95.0	89.24	20	60	12
501-211-0023	23	99.0	93.27	20	60	12
501-211-0024	24	103.0	97.29	20	60	12
501-211-0025	25	107.1	101.33	20	60	12

### Rollenkette DIN 8187

081-1  
1/2" x 1/8"  
12,7 x 3,3mm

Teilung 12,7mm  
Innere Breite 3,3mm  
Rollen ø 7,75mm

### Kettenrad DIN 8196

Zahnbreite B1 3,0mm  
Werkstoff: C45



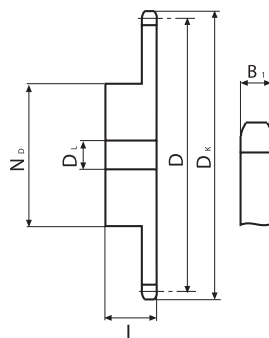

## Kettenräder – simplex

G&G-Best.-Nr.	Zz	D <sub>K</sub>	D	L	N <sub>b</sub>	D <sub>L</sub>
501-211-0026	26	111.2	105.36	20	70	16
501-211-0027	27	115.4	109.40	20	70	16
501-211-0028	28	119.4	113.42	20	70	16
501-211-0029	29	123.4	117.46	20	70	16
501-211-0030	30	127.5	121.50	20	70	16
501-211-0031	31	131.5	125.54	20	70	16
501-211-0032	32	135.5	129.56	20	70	16
501-211-0033	33	139.6	133.60	20	70	16
501-211-0034	34	143.6	137.64	20	70	16
501-211-0035	35	147.6	141.68	20	70	16
501-211-0036	36	151.7	145.72	25	70	16
501-211-0037	37	155.7	149.76	25	70	16
501-211-0038	38	159.8	153.80	25	70	16
501-211-0039	39	163.8	157.83	25	70	16
501-211-0040	40	167.8	161.87	25	70	16

### Rollenkette DIN 8187

081-1  
1/2" x 1/8"  
12,7 x 3,3mm

Teilung 12,7mm  
Innere Breite 3,3mm  
Rollen ø 7,75mm

### Kettenrad DIN 8196

Zahnbreite B1 3,0mm  
Werkstoff: C45

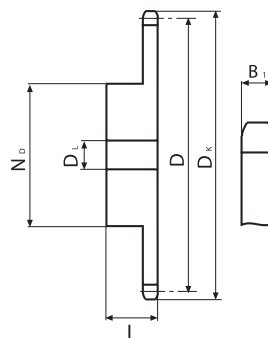

## Kettenräder – simplex

G&G-Best.-Nr	Zz	D <sub>K</sub>	D	L	N <sub>b</sub>	D <sub>L</sub>
501-231-0008	8	37.2	33.18	14	21	8
501-231-0009	9	41.5	37.13	14	25	8
501-231-0010	10	46.2	41.10	14	28	8
501-231-0011	11	49.6	45.07	16	31	8
501-231-0012	12	53.9	49.07	16	35	8
501-231-0013	13	58.4	53.06	16	39	8
501-231-0014	14	62.8	57.07	16	43	8
501-231-0015	15	66.8	61.09	16	47	8
501-231-0016	16	70.9	65.10	18	50	10
501-231-0017	17	74.9	69.11	18	50	10
501-231-0018	18	78.9	73.14	18	50	10
501-231-0019	19	82.9	77.16	18	50	10
501-231-0020	20	86.9	81.19	18	50	10
501-231-0021	21	91.0	85.22	20	60	12
501-231-0022	22	95.0	89.24	20	60	12
501-231-0023	23	99.0	93.27	20	60	12
501-231-0024	24	103.0	97.29	20	60	12
501-231-0025	25	107.1	101.33	20	60	12

### Rollenkette DIN 8187

083-1  
1/2" x 3/16"  
12,7 x 4,88mm

Teilung 12,7mm  
Innere Breite 4,88mm  
Rollen ø 7,75mm

### Kettenrad DIN 8196

Zahnbreite B1 4,5mm  
Werkstoff: C45

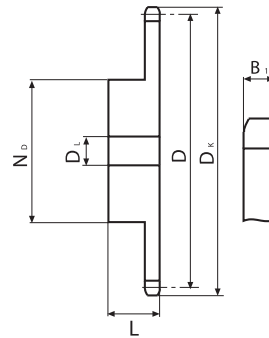

## Kettenräder – simplex

G&G-Best.-Nr	Zz	D <sub>k</sub>	D	L	N <sub>b</sub>	D <sub>L</sub>
501-231-0026	26	111.2	105.36	20	70	16
501-231-0027	27	115.4	109.40	20	70	16
501-231-0028	28	119.4	113.42	20	70	16
501-231-0029	29	123.4	117.46	20	70	16
501-231-0030	30	127.5	121.50	20	70	16
501-231-0031	31	131.5	125.54	20	70	16
501-231-0032	32	135.5	129.56	20	70	16
501-231-0033	33	139.6	133.60	20	70	16
501-231-0034	34	143.6	137.64	20	70	16
501-231-0035	35	147.6	141.68	20	70	16
501-231-0036	36	151.7	145.72	25	70	16
501-231-0037	37	155.7	149.76	25	70	16
501-231-0038	38	159.8	153.80	25	70	16
501-231-0039	39	163.8	157.83	25	70	16
501-231-0040	40	167.8	161.87	25	70	16

### Rollenkette DIN 8187

083-1  
1/2" x 3/16"  
12,7 x 4,88mm

Teilung 12,7mm  
Innere Breite 4,88mm  
Rollen ø 7,75mm

### Kettenrad DIN 8196

Zahnbreite B1 4,5mm  
Werkstoff: C45

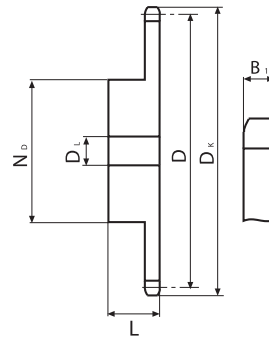

## Kettenräder – simplex

G&G-Best.-Nr.	Zz	Dk	D	L	ND	DL
501-201-0008	8	37.2	33.18	25	20	10
501-201-0009	9	41.5	37.13	25	24	10
501-201-0010	10	46.2	41.10	25	26	10
501-201-0011	11	49.6	45.07	25	29	10
501-201-0012	12	53.9	49.07	28	33	10
501-201-0013	13	58.4	53.06	28	37	10
501-201-0014	14	62.8	57.07	28	41	10
501-201-0015	15	66.8	61.09	28	45	10
501-201-0016	16	70.9	65.10	28	50	12
501-201-0017	17	74.9	69.11	28	52	12
501-201-0018	18	78.9	73.14	28	56	12
501-201-0019	19	82.9	77.16	28	60	12
501-201-0020	20	86.9	81.19	28	64	12
501-201-0021	21	91.0	85.22	28	68	12
501-201-0022	22	95.0	89.24	28	70	12
501-201-0023	23	99.0	93.27	28	70	14
501-201-0024	24	103.0	97.29	28	70	14
501-201-0025	25	107.1	101.33	28	70	14

### Rollenkette DIN 8187

08 B-1  
1/2 x 5/16"  
12,7 x 7,75mm

Teilung 12,7mm  
Innere Breite 7,75mm  
Rollen ø 8,51mm

### Kettenrad DIN 8196

Zahnbreite B1 7,2mm  
Werkstoff: C45

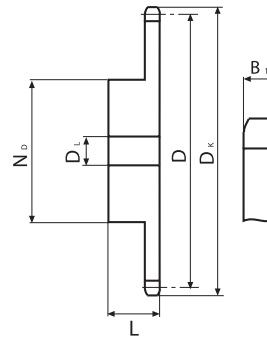

## Kettenräder – simplex

G&G-Best.-Nr.	Zz	D <sub>K</sub>	D	L	N <sub>b</sub>	D <sub>L</sub>
501-201-0026	26	111.2	105.36	30	70	16
501-201-0027	27	115.4	109.40	30	70	16
501-201-0028	28	119.4	113.42	30	70	16
501-201-0029	29	123.4	117.46	30	80	16
501-201-0030	30	127.5	121.50	30	80	16
501-201-0031	31	131.5	125.54	30	90	16
501-201-0032	32	135.5	129.56	30	90	16
501-201-0033	33	139.6	133.60	30	90	16
501-201-0034	34	143.6	137.64	30	90	16
501-201-0035	35	147.6	141.68	30	90	16
501-201-0036	36	151.7	145.72	35	90	16
501-201-0037	37	155.7	149.76	35	90	16
501-201-0038	38	159.8	153.80	35	90	16
501-201-0039	39	163.8	157.83	35	90	16
501-201-0040	40	167.8	161.87	35	90	16

### Rollenkette DIN 8187

08 B-1  
1/2 x 5/16"  
12,7 x 7,75mm

Teilung 12,7mm  
Innere Breite 7,75mm  
Rollen ø 8,51mm

### Kettenrad DIN 8196

Zahnbreite B1 7,2mm  
Werkstoff: C45

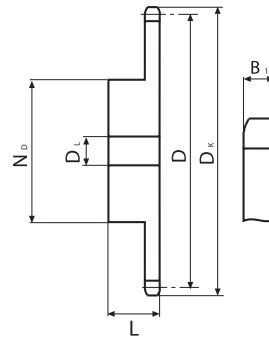

## Kettenräder – simplex

G&G-Best.-Nr.	Zz	D <sub>K</sub>	D	L	N <sub>b</sub>	D <sub>L</sub>
501-301-0008	8	47.0	41.48	25	25	10
501-301-0009	9	52.6	46.42	25	30	10
501-301-0010	10	57.5	51.37	25	35	10
501-301-0011	11	63.0	56.34	30	37	12
501-301-0012	12	68.0	61.34	30	42	12
501-301-0013	13	73.0	66.32	30	47	12
501-301-0014	14	78.0	71.34	30	52	12
501-301-0015	15	83.0	76.36	30	57	12
501-301-0016	16	88.0	81.37	30	60	12
501-301-0017	17	93.0	86.39	30	60	12
501-301-0018	18	98.3	91.42	30	70	14
501-301-0019	19	103.3	96.45	30	70	14
501-301-0020	20	108.4	101.49	30	75	14
501-301-0021	21	113.4	106.52	30	75	16
501-301-0022	22	118.0	111.55	30	80	16
501-301-0023	23	123.4	116.58	30	80	16
501-301-0024	24	128.3	121.62	30	80	16
501-301-0025	25	134.0	126.66	30	80	16

### Rollenkette DIN 8187

10 B-1  
5/8 x 3/8"  
15,875 x 9,65mm

Teilung 15,875mm  
Innere Breite 9,65mm  
Rollen ø 10,16mm

### Kettenrad DIN 8196

Zahnbreite B1 9,1mm  
Werkstoff: C45

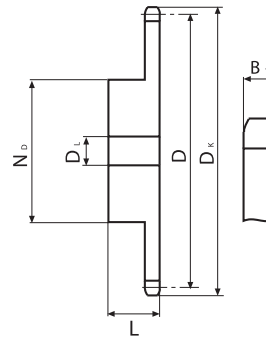

## Kettenräder – simplex

G&G-Best.-Nr.	Zz	D <sub>K</sub>	D	L	N <sub>b</sub>	D <sub>L</sub>
501-301-0026	26	139.0	131.70	35	85	20
501-301-0027	27	144.0	136.75	35	85	20
501-301-0028	28	148.7	141.78	35	90	20
501-301-0029	29	153.8	146.83	35	90	20
501-301-0030	30	158.8	151.87	35	90	20
501-301-0031	31	163.9	156.92	35	95	20
501-301-0032	32	168.9	161.95	35	95	20
501-301-0033	33	174.5	167.00	35	95	20
501-301-0034	34	179.0	172.05	35	95	20
501-301-0035	35	184.1	177.10	35	95	20
501-301-0036	36	189.1	182.15	35	100	20
501-301-0037	37	194.2	187.20	35	100	20
501-301-0038	38	199.2	192.24	35	100	20
501-301-0039	39	204.2	197.29	35	100	20
501-301-0040	40	209.3	202.34	35	100	20

### Rollenkette DIN 8187

10 B-1  
5/8 x 3/8"  
15,875 x 9,65mm

Teilung 15,875mm  
Innere Breite 9,65mm  
Rollen ø 10,16mm

### Kettenrad DIN 8196

Zahnbreite B1 9,1mm  
Werkstoff: C45

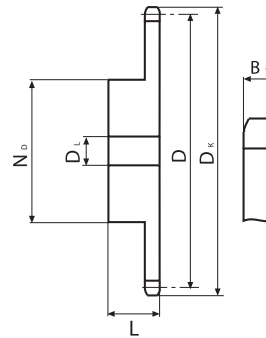

## Kettenräder – simplex

G&G-Best.-Nr.	Zz	D <sub>K</sub>	D	L	N <sub>b</sub>	D <sub>L</sub>
501-401-0008	8	57.6	49.78	30	31	12
501-401-0009	9	62.0	55.70	30	37	12
501-401-0010	10	69.0	61.64	30	42	12
501-401-0011	11	75.0	67.61	35	46	14
501-401-0012	12	81.5	73.60	35	52	14
501-401-0013	13	87.5	79.59	35	58	14
501-401-0014	14	93.6	85.61	35	64	14
501-401-0015	15	99.8	91.63	35	70	14
501-401-0016	16	105.5	97.65	35	75	16
501-401-0017	17	111.5	103.67	35	80	16
501-401-0018	18	118.0	109.71	35	80	16
501-401-0019	19	124.2	115.75	35	80	16
501-401-0020	20	129.7	121.78	35	80	16
501-401-0021	21	136.0	127.82	40	90	20
501-401-0022	22	141.8	133.86	40	90	20
501-401-0023	23	149.0	139.90	40	90	20
501-401-0024	24	153.9	145.94	40	90	20
501-401-0025	25	160.0	152.00	40	90	20

### Rollenkette DIN 8187

12 B-1	Teilung	19,05mm
3/4 x 7/16"	Innere Breite	11,68mm
19,05 x 11,68mm	Rollen ø	12,07mm

### Kettenrad DIN 8196

Zahnbreite B1	11,1mm
Werkstoff: C45	



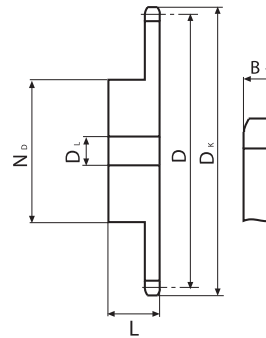

## Kettenräder – simplex

G&G-Best.-Nr.	Zz	D <sub>K</sub>	D	L	N <sub>b</sub>	D <sub>L</sub>
501-401-0026	26	165.9	158.04	40	95	20
501-401-0027	27	172.3	164.09	40	95	20
501-401-0028	28	178.0	170.13	40	95	20
501-401-0029	29	184.1	176.19	40	95	20
501-401-0030	30	190.5	182.25	40	95	20
501-401-0031	31	196.3	188.31	40	100	20
501-401-0032	32	203.3	194.35	40	100	20
501-401-0033	33	209.3	200.40	40	100	20
501-401-0034	34	214.6	206.46	40	100	20
501-401-0035	35	221.0	212.52	40	100	20
501-401-0036	36	226.8	218.58	40	100	20
501-401-0037	37	232.9	224.64	40	100	20
501-401-0038	38	239.0	230.69	40	100	20
501-401-0039	39	245.1	236.75	40	100	20
501-401-0040	40	251.3	242.81	40	100	20

### Rollenkette DIN 8187

12 B-1	Teilung	19,05mm
3/4 x 7/16"	Innere Breite	11,68mm
19,05 x 11,68mm	Rollen ø	12,07mm

### Kettenrad DIN 8196

Zahnbreite B1	11,1mm
Werkstoff: C45	

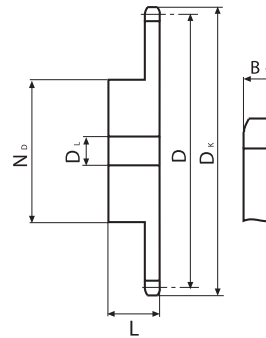

## Kettenräder – simplex

G&G-Best.-Nr.	Zz	D <sub>k</sub>	D	L	N <sub>b</sub>	D <sub>L</sub>
501-501-0008	8	77.0	66.37	35	42	16
501-501-0009	9	85.0	74.27	35	50	16
501-501-0010	10	93.0	82.19	35	55	16
501-501-0011	11	99.5	90.14	40	61	16
501-501-0012	12	109.0	98.14	40	69	16
501-501-0013	13	117.0	106.12	40	78	16
501-501-0014	14	125.0	114.15	40	84	16
501-501-0015	15	133.0	122.17	40	92	16
501-501-0016	16	141.0	130.20	45	100	20
501-501-0017	17	149.0	138.22	45	100	20
501-501-0018	18	157.0	146.28	45	100	20
501-501-0019	19	165.2	154.33	45	100	20
501-501-0020	20	173.2	162.38	45	100	20
501-501-0021	21	181.2	170.43	50	110	20
501-501-0022	22	189.3	178.48	50	110	20
501-501-0023	23	197.5	186.53	50	110	20
501-501-0024	24	205.5	194.59	50	110	20
501-501-0025	25	213.5	202.66	50	110	20

### Rollenkette DIN 8187

16 B-1	Teilung	25,40mm
1" x 17,02mm	Innere Breite	17,02mm
25,4 x 17,02mm	Rollen ø	15,88mm

### Kettenrad DIN 8196

Zahnbreite B1	16,2mm
ab Zähnezahl 31 mit geschweißter Nabe	
Werkstoff: C45	

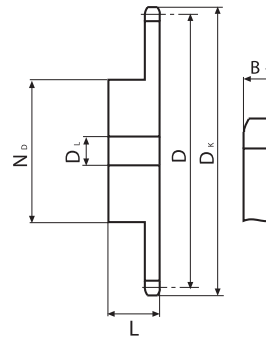

## Kettenräder – simplex

G&G-Best.-Nr.	Zz	D <sub>K</sub>	D	L	N <sub>b</sub>	D <sub>L</sub>
501-501-0026	26	221.6	210.72	50	120	20
501-501-0027	27	229.6	218.79	50	120	20
501-501-0028	28	237.7	226.85	50	120	20
501-501-0029	29	245.8	234.92	50	120	20
501-501-0030	30	254.0	243.00	50	120	20
501-501-0031	31	262.0	251.08	50	120	25
501-501-0032	32	270.0	259.13	50	120	25
501-501-0033	33	278.5	267.21	50	120	25
501-501-0034	34	287.0	275.28	50	120	25
501-501-0035	35	296.2	283.36	50	120	25
501-501-0036	36	304.6	291.44	50	120	25
501-501-0037	37	312.6	299.51	50	120	25
501-501-0038	38	320.7	307.59	50	120	25
501-501-0039	39	328.8	315.67	50	120	25
501-501-0040	40	336.9	323.73	50	120	25

### Rollenkette DIN 8187

16 B-1	Teilung	25,40mm
1" x 17,02mm	Innere Breite	17,02mm
25,4 x 17,02mm	Rollen ø	15,88mm

### Kettenrad DIN 8196

Zahnbreite B1	16,2mm
ab Zähnezahl 31 mit geschweißter Nabe	
Werkstoff: C45	

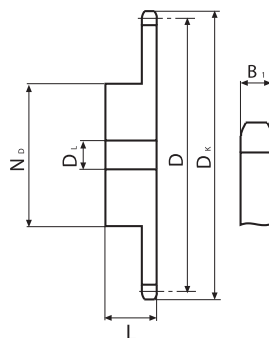

## Kettenräder – simplex

G&G-Best.-Nr.	Zz	D <sub>K</sub>	D	L	N <sub>b</sub>	D <sub>L</sub>
501-601-0008	8	98.1	82.96	40	53	20
501-601-0009	9	108.0	92.84	40	63	20
501-601-0010	10	117.9	102.74	40	70	20
501-601-0011	11	127.8	112.68	45	77	20
501-601-0012	12	137.8	122.68	45	88	20
501-601-0013	13	147.8	132.65	45	98	20
501-601-0014	14	157.8	142.68	45	108	20
501-601-0015	15	167.9	152.72	45	118	20
501-601-0016	16	177.9	162.75	50	120	25
501-601-0017	17	187.9	172.78	50	120	25
501-601-0018	18	198.0	182.85	50	120	25
501-601-0019	19	208.1	192.91	50	120	25
501-601-0020	20	218.1	202.98	50	120	25
501-601-0021	21	228.2	213.04	55	140	25
501-601-0022	22	238.3	223.11	55	140	25
501-601-0023	23	248.3	233.17	55	140	25
501-601-0024	24	258.4	243.23	55	140	25
501-601-0025	25	268.5	253.33	55	140	25

### Rollenkette DIN 8187

20 B-1  
1 1/4" x 3/4"  
31,75 x 19,56mm

Teilung 31,75mm  
Innere Breite 19,56mm  
Rollen ø 19,05mm

### Kettenrad DIN 8196

Zahnbreite B1 18,5mm  
ab Zähnezahl 26 mit geschweißter Nabe  
Werkstoff: C45

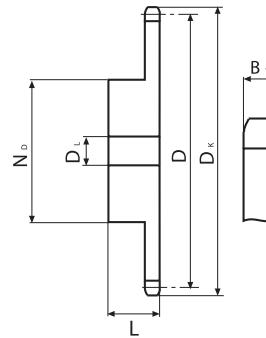

## Kettenräder – simplex

G&G-Best.-Nr.	Zz	D <sub>K</sub>	D	L	N <sub>b</sub>	D <sub>L</sub>
501-601-0026	26	278.6	263.40	55	150	25
501-601-0027	27	288.6	273.48	55	150	25
501-601-0028	28	298.7	283.56	55	150	25
501-601-0029	29	308.8	293.65	55	150	25
501-601-0030	30	318.9	303.75	55	150	25
501-601-0031	31	329.0	313.85	55	150	25
501-601-0032	32	339.1	323.91	55	150	25
501-601-0033	33	349.2	334.01	55	150	25
501-601-0034	34	359.3	344.10	55	150	25
501-601-0035	35	369.4	354.20	55	150	25
501-601-0036	36	379.5	364.30	55	150	25
501-601-0037	37	389.5	374.39	55	150	25
501-601-0038	38	399.6	384.49	55	150	25
501-601-0039	39	409.7	394.59	55	150	25
501-601-0040	40	419.8	404.66	55	150	25

### Rollenkette DIN 8187

20 B-1  
1 1/4" x 3/4"  
31,75 x 19,56mm

Teilung 31,75mm  
Innere Breite 19,56mm  
Rollen ø 19,05mm

### Kettenrad DIN 8196

Zahnbreite B1 18,5mm  
ab Zähnezahl 26 mit geschweißter Nabe  
Werkstoff: C45

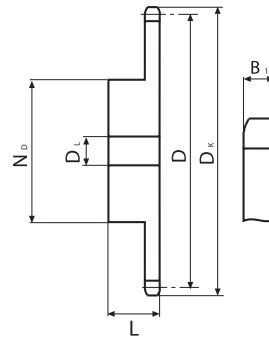

## Kettenräder – simplex

G&G-Best.-Nr	Zz	D <sub>K</sub>	D	L	N <sub>b</sub>	D <sub>L</sub>
501-701-0008	8	115.0	99.55	45	58	20
501-701-0009	9	126.4	111.40	45	70	20
501-701-0010	10	138.0	123.29	45	80	20
501-701-0011	11	150.0	135.21	50	90	25
501-701-0012	12	162.0	147.22	50	102	25
501-701-0013	13	174.2	159.18	50	114	25
501-701-0014	14	186.2	171.22	50	128	25
501-701-0015	15	198.2	183.26	50	140	25
501-701-0016	16	210.3	195.30	55	140	25
501-701-0017	17	222.3	207.34	55	140	25
501-701-0018	18	234.3	219.42	55	140	25
501-701-0019	19	246.5	231.49	55	140	25
501-701-0020	20	258.6	243.57	55	140	25
501-701-0021	21	270.6	255.65	60	150	25
501-701-0022	22	282.7	267.73	60	150	25
501-701-0023	23	294.8	279.80	60	150	25
501-701-0024	24	306.8	291.88	60	150	25
501-701-0025	25	319.0	304.00	60	150	25

### Rollenkette DIN 8187

24 B-1  
1 1/2" x 1"  
38,1 x 25,4mm

Teilung 38,1mm  
Innere Breite 25,4mm  
Rollen ø 25,4mm

### Kettenrad DIN 8196

Zahnbreite B1 24,1mm  
ab Zähnezahl 16 mit geschweißter Nabe  
Werkstoff: C45

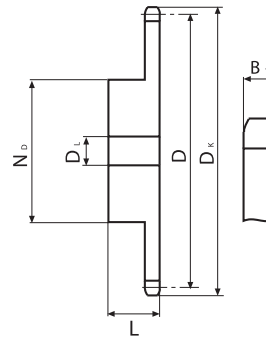

## Kettenräder – simplex

G&G-Best.-Nr	Zz	D <sub>k</sub>	D	L	N <sub>b</sub>	D <sub>L</sub>
501-701-0026	26	331.0	316.08	60	160	30
501-701-0027	27	343.2	328.19	60	160	30
501-701-0028	28	355.2	340.27	60	160	30
501-701-0029	29	367.3	352.38	60	160	30
501-701-0030	30	379.5	364.50	60	160	30
501-701-0031	31	391.6	376.62	60	160	30
501-701-0032	32	403.7	388.69	60	160	30
501-701-0033	33	415.8	400.81	60	160	30
501-701-0034	34	427.8	412.93	60	160	30
501-701-0035	35	440.0	425.04	60	160	30
501-701-0036	36	452.0	437.16	60	160	30
501-701-0037	37	464.2	449.27	60	160	30
501-701-0038	38	476.2	461.39	60	160	30
501-701-0039	39	488.5	473.50	60	160	30
501-701-0040	40	500.6	485.62	60	160	30

### Rollenkette DIN 8187

24 B-1  
1 1/2" x 1"  
38,1 x 25,4mm

Teilung 38,1mm  
Innere Breite 25,4mm  
Rollen ø 25,4mm

### Kettenrad DIN 8196

Zahnbreite B1 24,1mm  
ab Zähnezahl 16 mit geschweißter Nabe  
Werkstoff: C45

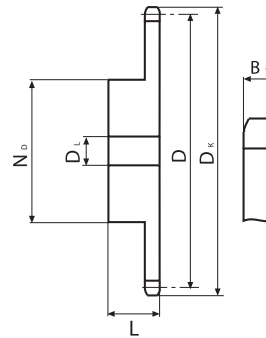

## Kettenräder – simplex

G&G-Best.-Nr.	Zz	D <sub>K</sub>	D	L	N <sub>b</sub>	D <sub>L</sub>
501-751-0008	8	132.0	116.15	70	74	25
501-751-0009	9	148.4	129.96	70	88	25
501-751-0010	10	162.3	143.85	70	100	25
501-751-0011	11	176.3	157.77	70	112	25
501-751-0012	12	189.3	171.74	70	125	25
501-751-0013	13	204.2	185.75	70	130	25
501-751-0014	14	218.2	199.76	70	130	25
501-751-0015	15	232.3	213.79	70	145	25
501-751-0016	16	246.3	227.84	75	160	30
501-751-0017	17	260.0	241.90	75	160	30
501-751-0018	18	274.0	255.98	75	160	30
501-751-0019	19	289.0	270.06	75	160	30
501-751-0020	20	303.0	284.15	75	160	30
501-751-0021	21	317.0	298.24	75	170	30
501-751-0022	22	331.0	312.34	75	170	30
501-751-0023	23	345.0	326.44	75	170	30
501-751-0024	24	359.0	340.55	75	170	30
501-751-0025	25	373.0	354.66	75	170	30

### Rollenkette DIN 8187

28 B-1  
1 3/4" x 1 1/4"  
44,45 x 30,99mm

Teilung 44,45mm  
Innere Breite 30,99mm  
Rollen ø 27,94mm

### Kettenrad DIN 8196

Zahnbreite B1 29,4mm  
ab Zähnezahl 13 mit geschweißter Nabe  
Werkstoff: C45



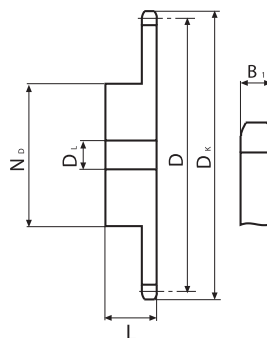

## Kettenräder – simplex

G&G-Best.-Nr.	Zz	D <sub>k</sub>	D	L	N <sub>b</sub>	D <sub>L</sub>
501-751-0026	26	387.0	368.77	75	170	30
501-751-0027	27	401.0	382.88	75	170	30
501-751-0028	28	416.0	397.00	75	170	30
501-751-0029	29	430.0	411.12	75	170	30
501-751-0030	30	444.0	425.24	75	170	30
501-751-0031	31	458.0	439.37	75	180	30
501-751-0032	32	472.0	453.49	75	180	30
501-751-0033	33	486.0	467.62	75	180	30
501-751-0034	34	500.0	481.75	75	180	30
501-751-0035	35	514.0	495.88	75	180	30
501-751-0036	36	529.0	510.01	75	180	30
501-751-0037	37	543.0	524.13	75	180	30
501-751-0038	38	557.0	538.27	75	180	30
501-751-0039	39	571.0	552.40	75	180	30
501-751-0040	40	585.0	566.54	75	180	30

### Rollenkette DIN 8187

28 B-1  
1 3/4" x 1 1/4"  
44,45 x 30,99mm

Teilung 44,45mm  
Innere Breite 30,99mm  
Rollen ø 27,94mm

### Kettenrad DIN 8196

Zahnbreite B1 29,4mm  
ab Zähnezahl 13 mit geschweißter Nabe  
Werkstoff: C45

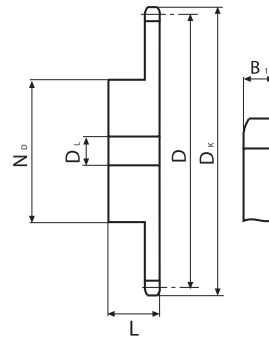

## Kettenräder – simplex

G&G-Best.-Nr.	Zz	D <sub>K</sub>	D	L	N <sub>b</sub>	D <sub>L</sub>
501-801-0008	8	152.0	132.74	80	85	30
501-801-0009	9	168.0	148.54	80	100	30
501-801-0010	10	184.0	164.39	80	115	30
501-801-0011	11	200.0	180.31	80	125	30
501-801-0012	12	216.0	196.29	80	133	30
501-801-0013	13	235.0	212.29	80	145	30
501-801-0014	14	251.0	228.29	80	145	30
501-801-0015	15	267.0	244.30	80	145	30
501-801-0016	16	283.0	260.40	90	160	30
501-801-0017	17	299.0	276.46	90	160	30
501-801-0018	18	315.0	292.55	90	160	30
501-801-0019	19	331.0	308.66	90	160	30
501-801-0020	20	347.0	324.71	90	180	40
501-801-0021	21	363.0	340.82	90	180	40
501-801-0022	22	379.0	356.98	90	180	40
501-801-0023	23	396.0	373.08	90	180	40
501-801-0024	24	412.0	389.18	90	180	40
501-801-0025	25	428.0	405.33	90	180	40

### Rollenkette DIN 8187

32 B-1  
2" x 1 1/4"  
50,8 x 30,99mm

Teilung 50,8mm  
Innere Breite 30,99mm  
Rollen ø 29,21mm

### Kettenrad DIN 8196

Zahnbreite B1 28,8mm  
ab Zähnezahl 22 mit geschweißter Nabe  
Werkstoff: C45

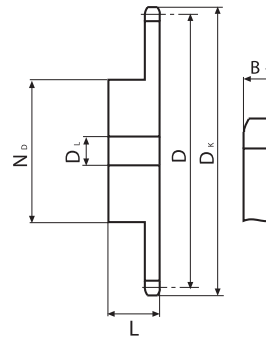

## Kettenräder – simplex

G&G-Best.-Nr.	Zz	D <sub>K</sub>	D	L	N <sub>b</sub>	D <sub>L</sub>
501-801-0026	26	444.0	421.44	90	180	40
501-801-0028	28	476.0	453.69	90	180	40
501-801-0030	30	508.0	486.00	90	180	40
501-801-0032	32	541.0	518.27	90	200	40
501-801-0035	35	589.0	566.71	90	200	40
501-801-0038	38	638.0	615.16	90	200	40
501-801-0040	40	670.0	647.47	90	200	40
501-801-0045	45	751.0	728.24	123	218	40
501-801-0050	50	832.0	809.04	123	218	40
501-801-0057	57	945.0	922.16	123	218	40
501-801-0060	60	993.0	970.65	123	218	40
501-801-0076	76	1252.0	1229.27	123	218	40

### Rollenkette DIN 8187

32 B-1  
2" x 1 1/4"  
50,8 x 30,99mm

Teilung 50,8mm  
Innere Breite 30,99mm  
Rollen ø 29,21mm

### Kettenrad DIN 8196

Zahnbreite B1 28,8mm  
ab Zähnezahl 22 mit geschweißter Nabe  
Werkstoff: C45

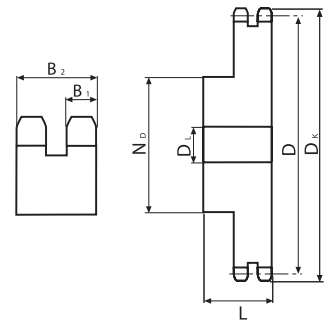

## Kettenräder – duplex

G&G-Best.-Nr.	Zz	D <sub>K</sub>	D	L	N <sub>b</sub>	D <sub>L</sub>
501-082-0008	8	24.0	20.90	18	12	8
501-082-0009	9	26.6	23.39	18	15	8
501-082-0010	10	29.2	25.89	18	17	8
501-082-0011	11	31.7	28.39	18	19	10
501-082-0012	12	34.2	30.91	18	21	10
501-082-0013	13	36.7	33.42	18	24	10
501-082-0014	14	39.2	35.95	18	26	10
501-082-0015	15	41.7	38.48	18	29	10
501-082-0016	16	44.3	41.01	20	32	10
501-082-0017	17	46.8	43.53	20	34	10
501-082-0018	18	49.3	46.07	20	37	10
501-082-0019	19	51.9	48.61	20	39	10
501-082-0020	20	54.4	51.14	20	40	10
501-082-0021	21	57.0	53.67	20	40	10
501-082-0022	22	59.5	56.21	20	40	10
501-082-0023	23	62.0	58.75	20	40	10
501-082-0024	24	64.6	61.29	20	40	10
501-082-0025	25	67.5	63.83	20	40	10

### Rollenkette DIN 8187

05 B-2  
8,0 x 3,0mm

Teilung 8,0mm  
Innere Breite 3,0mm  
Rollen ø 5,0mm

### Kettenrad DIN 8196

Zahnbreite B1 2,8mm  
Zahnbreite B2 8,3mm  
Werkstoff: C45

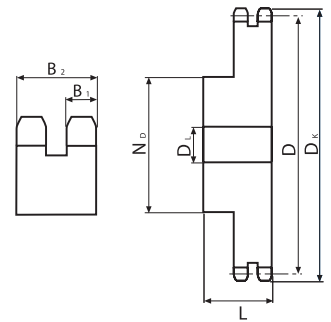

## Kettenräder – duplex

G&G-Best.-Nr.	Zz	D <sub>K</sub>	D	L	N <sub>b</sub>	D <sub>L</sub>
501-082-0026	26	69.5	66.37	22	50	12
501-082-0027	27	72.2	68.91	22	50	12
501-082-0028	28	74.8	71.45	22	50	12
501-082-0029	29	77.3	73.99	22	50	12
501-082-0030	30	79.8	76.53	22	50	12
501-082-0031	31	82.4	79.08	22	60	12
501-082-0032	32	84.9	81.61	22	60	12
501-082-0033	33	87.5	84.16	22	60	12
501-082-0034	34	90.0	86.70	22	60	12
501-082-0035	35	92.5	89.24	22	60	12
501-082-0036	36	95.0	91.79	22	60	12
501-082-0037	37	97.6	94.33	22	60	12
501-082-0038	38	100.2	96.88	22	60	12
501-082-0039	39	102.7	99.42	22	60	12
501-082-0040	40	105.2	101.97	22	60	12

### Rollenkette DIN 8187

05 B-2  
8,0 x 3,0mm

Teilung 8,0mm  
Innere Breite 3,0mm  
Rollen ø 5,0mm

### Kettenrad DIN 8196

Zahnbreite B1 2,8mm  
Zahnbreite B2 8,3mm  
Werkstoff: C45

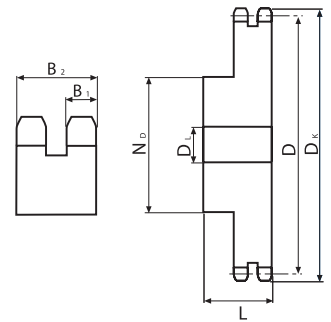

## Kettenräder – duplex

G&G-Best.-Nr.	Zz	D <sub>K</sub>	D	L	N <sub>b</sub>	D <sub>L</sub>
501-102-0008	8	28.0	24.89	22	15	6
501-102-0009	9	31.0	27.85	22	18	8
501-102-0010	10	34.0	30.82	22	20	8
501-102-0011	11	37.0	33.80	25	22	10
501-102-0012	12	40.0	36.80	25	25	10
501-102-0013	13	43.0	39.80	25	28	10
501-102-0014	14	46.3	42.80	25	31	10
501-102-0015	15	49.3	45.81	25	34	10
501-102-0016	16	52.3	48.82	30	37	12
501-102-0017	17	55.3	51.83	30	40	12
501-102-0018	18	58.3	54.85	30	43	12
501-102-0019	19	61.3	57.87	30	46	12
501-102-0020	20	64.3	60.89	30	49	12
501-102-0021	21	68.0	63.91	30	52	12
501-102-0022	22	71.0	66.93	30	55	12
501-102-0023	23	73.5	69.95	30	58	12
501-102-0024	24	77.0	72.97	30	61	12
501-102-0025	25	80.0	76.00	30	64	12

### Rollenkette DIN 8187

06 B-2  
3/8 x 7/32"  
9,525 x 5,72mm

Teilung 9,525mm  
Innere Breite 5,72mm  
Rollen ø 6,35mm

### Kettenrad DIN 8196

Zahnbreite B1 5,3mm  
Zahnbreite B2 15,4mm  
Werkstoff: C45

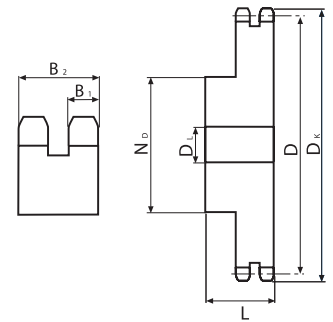

## Kettenräder – duplex

G&G-Best.-Nr.	Zz	D <sub>K</sub>	D	L	N <sub>b</sub>	D <sub>L</sub>
501-102-0026	26	83.0	79.02	30	67	12
501-102-0027	27	86.0	82.04	30	70	12
501-102-0028	28	89.0	85.07	30	73	12
501-102-0029	29	92.0	88.09	30	76	12
501-102-0030	30	94.7	91.12	30	79	12
501-102-0031	31	98.3	94.15	30	80	16
501-102-0032	32	101.3	97.17	30	80	16
501-102-0033	33	104.3	100.20	30	80	16
501-102-0034	34	107.3	103.23	30	80	16
501-102-0035	35	110.4	106.26	30	80	16
501-102-0036	36	113.4	109.29	30	90	16
501-102-0037	37	116.4	112.32	30	90	16
501-102-0038	38	119.5	115.34	30	90	16
501-102-0039	39	122.5	118.37	30	90	16
501-102-0040	40	125.5	121.40	30	90	16

### Rollenkette DIN 8187

06 B-2  
3/8 x 7/32"  
9,525 x 5,72mm

Teilung 9,525mm  
Innere Breite 5,72mm  
Rollen ø 6,35mm

### Kettenrad DIN 8196

Zahnbreite B1 5,3mm  
Zahnbreite B2 15,4mm  
Werkstoff: C45

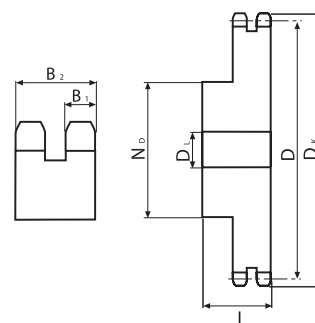

## Kettenräder – duplex

G&G-Best.-Nr.	Zz	D <sub>K</sub>	D	L	N <sub>b</sub>	D <sub>L</sub>
501-202-0008	8	37.20	33.18	32	20	10
501-202-0009	9	41.50	37.13	32	24	10
501-202-0010	10	46.20	41.10	32	28	10
501-202-0011	11	49.60	45.07	35	32	12
501-202-0012	12	53.90	49.07	35	35	12
501-202-0013	13	58.40	53.06	35	38	12
501-202-0014	14	62.80	57.07	35	42	12
501-202-0015	15	66.80	61.09	35	46	12
501-202-0016	16	70.90	65.10	35	50	14
501-202-0017	17	74.90	69.11	35	54	14
501-202-0018	18	78.90	73.14	35	58	14
501-202-0019	19	82.90	77.16	35	62	14
501-202-0020	20	86.90	81.19	35	66	14
501-202-0021	21	91.00	85.22	40	70	16
501-202-0022	22	95.00	89.24	40	70	16
501-202-0023	23	99.00	93.27	40	70	16
501-202-0024	24	103.00	97.29	40	75	16
501-202-0025	25	107.10	101.33	40	80	16

### Rollenkette DIN 8187

08 B-2  
1/2 x 5/16"  
12,7 x 7,75mm

Teilung 12,7mm  
Innere Breite 7,75mm  
Rollen ø 8,51mm

### Kettenrad DIN 8196

Zahnbreite B1 7,2mm  
Zahnbreite B2 21,0mm  
Werkstoff: C45



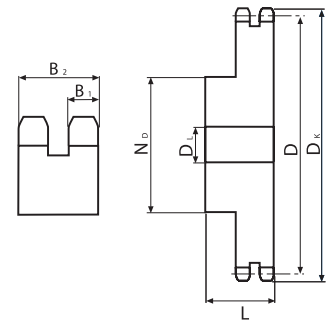

## Kettenräder – duplex

G&G-Best.-Nr.	Zz	D <sub>k</sub>	D	L	N <sub>b</sub>	D <sub>1</sub>
501-202-0026	26	111.20	105.36	40	85	20
501-202-0027	27	115.40	109.40	40	85	20
501-202-0028	28	119.40	113.42	40	90	20
501-202-0029	29	123.40	117.46	40	95	20
501-202-0030	30	127.50	121.50	40	100	20
501-202-0031	31	131.50	125.54	40	100	20
501-202-0032	32	135.50	129.56	40	100	20
501-202-0033	33	139.60	133.60	40	100	20
501-202-0034	34	143.60	137.64	40	100	20
501-202-0035	35	147.60	141.68	40	100	20
501-202-0036	36	151.70	145.72	40	110	20
501-202-0037	37	155.70	149.76	40	110	20
501-202-0038	38	159.80	153.80	40	110	20
501-202-0039	39	163.80	157.83	40	110	20
501-202-0040	40	167.80	161.87	40	110	20

### Rollenkette DIN 8187

08 B-2	Teilung	12,7mm
1/2 x 5/16"	Innere Breite	7,75mm
12,7 x 7,75mm	Rollen ø	8,51mm

### Kettenrad DIN 8196

Zahnbreite B1	7,2mm
Zahnbreite B2	21,0mm
Werkstoff: C45	

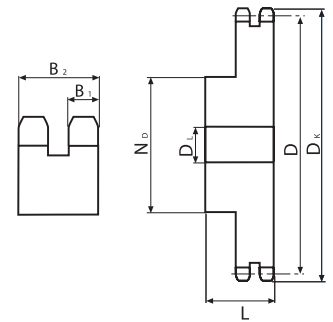

## Kettenräder – duplex

G&G-Best.-Nr.	Zz	D <sub>K</sub>	D	L	N <sub>b</sub>	D <sub>L</sub>
501-302-0008	8	47.0	41.48	40	25	12
501-302-0009	9	52.6	46.42	40	30	12
501-302-0010	10	57.5	51.37	40	35	12
501-302-0011	11	63.0	56.34	40	39	14
501-302-0012	12	68.0	61.34	40	44	14
501-302-0013	13	73.0	66.32	40	49	14
501-302-0014	14	78.0	71.34	40	54	14
501-302-0015	15	83.0	76.36	40	59	14
501-302-0016	16	88.0	81.37	45	64	16
501-302-0017	17	93.0	86.39	45	69	16
501-302-0018	18	98.3	91.42	45	74	16
501-302-0019	19	103.3	96.45	45	79	16
501-302-0020	20	108.4	101.49	45	84	16
501-302-0021	21	113.4	106.52	45	85	16
501-302-0022	22	118.0	111.55	45	90	16
501-302-0023	23	123.4	116.58	45	95	16
501-302-0024	24	128.3	121.62	45	100	16
501-302-0025	25	134.0	126.66	45	105	16

### Rollenkette DIN 8187

10 B-2	Teilung	15,875mm
5/8 x 3/8"	Innere Breite	9,65mm
15,875 x 9,65mm	Rollen ø	10,16mm

### Kettenrad DIN 8196

Zahnbreite B1	9,1mm
Zahnbreite B2	25,5mm
Werkstoff:	C45

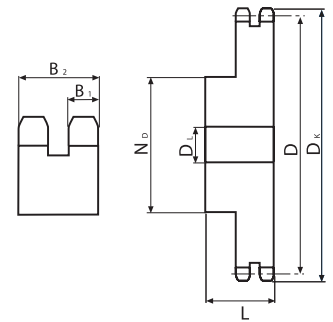

## Kettenräder – duplex

G&G-Best.-Nr.	Zz	D <sub>K</sub>	D	L	N <sub>b</sub>	D <sub>L</sub>
501-302-0026	26	139.0	131.70	45	110	20
501-302-0027	27	144.0	136.75	45	110	20
501-302-0028	28	148.7	141.78	45	115	20
501-302-0029	29	153.8	146.83	45	115	20
501-302-0030	30	158.8	151.87	45	120	20
501-302-0031	31	163.9	156.92	45	120	20
501-302-0032	32	168.9	161.95	45	120	20
501-302-0033	33	174.5	167.00	45	120	20
501-302-0034	34	179.0	172.05	45	120	20
501-302-0035	35	184.1	177.10	45	120	20
501-302-0036	36	189.1	182.15	45	120	20
501-302-0037	37	194.2	187.20	45	120	20
501-302-0038	38	199.2	192.24	45	120	20
501-302-0039	39	204.2	197.29	45	120	20
501-302-0040	40	209.3	202.34	45	120	20

### Rollenkette DIN 8187

10 B-2  
5/8 x 3/8"  
15,875 x 9,65mm

Teilung 15,875mm  
Innere Breite 9,65mm  
Rollen ø 10,16mm

### Kettenrad DIN 8196

Zahnbreite B1 9,1mm  
Zahnbreite B2 25,5mm  
Werkstoff: C45

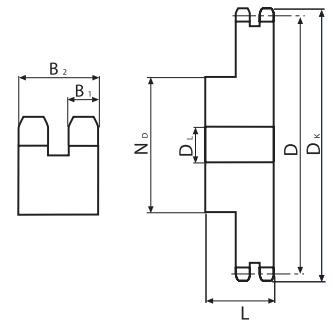

## Kettenräder – duplex

G&G-Best.-Nr.	Zz	D <sub>K</sub>	D	L	N <sub>b</sub>	D <sub>L</sub>
501-402-0008	8	57.6	49.78	45	31	12
501-402-0009	9	62.0	55.70	45	37	12
501-402-0010	10	69.0	61.64	45	42	12
501-402-0011	11	75.0	67.61	50	47	16
501-402-0012	12	81.5	73.60	50	53	16
501-402-0013	13	87.5	79.59	50	59	16
501-402-0014	14	93.6	85.61	50	65	16
501-402-0015	15	99.8	91.63	50	71	16
501-402-0016	16	105.5	97.65	50	77	20
501-402-0017	17	111.5	103.67	50	83	20
501-402-0018	18	118.0	109.71	50	89	20
501-402-0019	19	124.2	115.75	50	95	20
501-402-0020	20	129.7	121.78	50	100	20
501-402-0021	21	136.0	127.82	50	100	20
501-402-0022	22	141.8	133.86	50	100	20
501-402-0023	23	149.0	139.90	50	110	20
501-402-0024	24	153.9	145.94	50	110	20
501-402-0025	25	160.0	152.00	50	120	20

### Rollenkette DIN 8187

12 B-2	Teilung	19,05mm
3/4 x 7/16"	Innere Breite	11,68mm
19,05 x 11,68mm	Rollen ø	12,07mm

### Kettenrad DIN 8196

Zahnbreite B1	11,1mm
Zahnbreite B2	30,3mm
Werkstoff: C45	

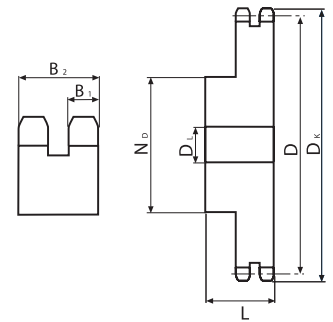

## Kettenräder – duplex

G&G-Best.-Nr.	Zz	D <sub>K</sub>	D	L	N <sub>b</sub>	D <sub>L</sub>
501-402-0026	26	165.9	158.04	50	120	20
501-402-0027	27	172.3	164.09	50	120	20
501-402-0028	28	178.0	170.13	50	120	20
501-402-0029	29	184.1	176.19	50	120	20
501-402-0030	30	190.5	182.25	50	120	20
501-402-0031	31	196.3	188.31	50	130	20
501-402-0032	32	203.3	194.35	50	130	20
501-402-0033	33	209.3	200.40	50	130	20
501-402-0034	34	214.6	206.46	50	130	20
501-402-0035	35	221.0	212.52	50	130	20
501-402-0036	36	226.8	218.58	50	130	25
501-402-0037	37	232.9	224.64	50	130	25
501-402-0038	38	239.0	230.69	50	130	25
501-402-0039	39	245.1	236.75	50	130	25
501-402-0040	40	251.3	242.81	50	130	25

### Rollenkette DIN 8187

12 B-2	Teilung	19,05mm
3/4 x 7/16"	Innere Breite	11,68mm
19,05 x 11,68mm	Rollen ø	12,07mm

### Kettenrad DIN 8196

Zahnbreite B1	11,1mm
Zahnbreite B2	30,3mm
Werkstoff: C45	

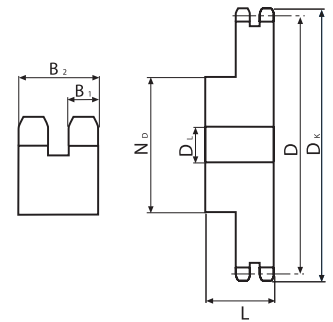

## Kettenräder – duplex

G&G-Best.-Nr.	Zz	D <sub>K</sub>	D	L	N <sub>b</sub>	D <sub>L</sub>
501-502-0008	8	77.0	66.37	65	42	16
501-502-0009	9	85.0	74.27	65	50	16
501-502-0010	10	93.0	82.19	65	56	16
501-502-0011	11	99.5	90.14	70	64	20
501-502-0012	12	109.0	98.14	70	72	20
501-502-0013	13	117.0	106.12	70	80	20
501-502-0014	14	125.0	114.15	70	88	20
501-502-0015	15	133.0	122.17	70	96	20
501-502-0016	16	141.0	130.20	70	104	20
501-502-0017	17	149.0	138.22	70	112	20
501-502-0018	18	157.0	146.28	70	120	20
501-502-0019	19	165.2	154.33	70	128	20
501-502-0020	20	173.2	162.38	70	130	20
501-502-0021	21	181.2	170.43	70	130	25
501-502-0022	22	189.3	178.48	70	130	25
501-502-0023	23	197.5	186.53	70	130	25
501-502-0024	24	205.5	194.59	70	130	25
501-502-0025	25	213.5	202.66	70	130	25

### Rollenkette DIN 8187

16 B-2	Teilung	25,40mm
1" x 17,02mm	Innere Breite	17,02mm
25,4 x 17,02mm	Rollen ø	15,88mm

### Kettenrad DIN 8196

Zahnbreite B1	16,2mm
Zahnbreite B2	47,7mm
ab Zähnezahl 21 mit geschweißter Nabe	
Werkstoff: C45	

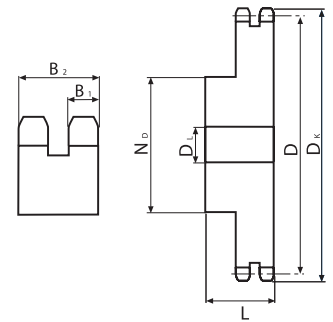

## Kettenräder – duplex

G&G-Best.-Nr.	Zz	D <sub>K</sub>	D	L	N <sub>b</sub>	D <sub>L</sub>
501-502-0026	26	221.6	210.72	70	130	25
501-502-0027	27	229.6	218.79	70	130	25
501-502-0028	28	237.7	226.85	70	130	25
501-502-0029	29	245.8	234.92	70	130	25
501-502-0030	30	254.0	243.00	70	130	25
501-502-0031	31	262.0	251.08	70	140	25
501-502-0032	32	270.0	259.13	70	140	25
501-502-0033	33	278.5	267.21	70	140	25
501-502-0034	34	287.0	275.28	70	140	25
501-502-0035	35	296.2	283.36	70	140	25
501-502-0036	36	304.6	291.44	70	140	25
501-502-0037	37	312.6	299.51	70	140	25
501-502-0038	38	320.7	307.59	70	140	25
501-502-0039	39	328.8	315.67	70	140	25
501-502-0040	40	336.9	323.73	70	140	25

### Rollenkette DIN 8187

16 B-2	Teilung	25,40mm
1" x 17,02mm	Innere Breite	17,02mm
25,4 x 17,02mm	Rollen ø	15,88mm

### Kettenrad DIN 8196

Zahnbreite B1	16,2mm
Zahnbreite B2	47,7mm
ab Zähnezahl 21 mit geschweißter Nabe	
Werkstoff: C45	

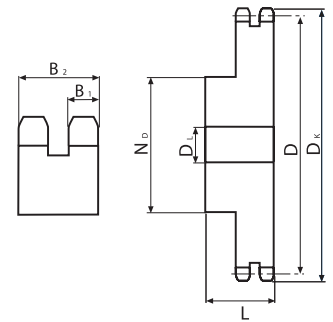

## Kettenräder – duplex

G&G-Best.-Nr.	Zz	D <sub>K</sub>	D	L	N <sub>b</sub>	D <sub>L</sub>
501-602-0008	8	98.1	82.96	75	53	20
501-602-0009	9	108.0	92.84	75	63	20
501-602-0010	10	117.9	102.74	75	70	20
501-602-0011	11	127.8	112.68	80	80	20
501-602-0012	12	137.8	122.68	80	90	20
501-602-0013	13	147.8	132.65	80	100	20
501-602-0014	14	157.8	142.68	80	110	20
501-602-0015	15	167.9	152.72	80	120	20
501-602-0016	16	177.9	162.75	80	120	25
501-602-0017	17	187.9	172.78	80	120	25
501-602-0018	18	198.0	182.85	80	120	25
501-602-0019	19	208.1	192.91	80	120	25
501-602-0020	20	218.1	202.98	80	120	25
501-602-0021	21	228.2	213.04	80	140	25
501-602-0022	22	238.3	223.11	80	140	25
501-602-0023	23	248.3	233.17	80	140	25
501-602-0024	24	258.4	243.23	80	140	25
501-602-0025	25	268.5	253.33	80	140	25

### Rollenkette DIN 8187

20 B-2	Teilung	31,75mm
1 1/4" x 3/4"	Innere Breite	19,56mm
31,75 x 19,56mm	Rollen ø	19,05mm

### Kettenrad DIN 8196

Zahnbreite B1	18,5mm
Zahnbreite B2	54,6mm
ab Zähnezahl 18 mit geschweißter Nabe	
Werkstoff:	C45



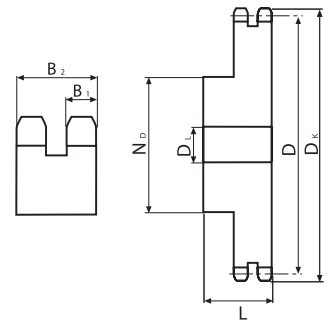

## Kettenräder – duplex

G&G-Best.-Nr.	Zz	D <sub>K</sub>	D	L	N <sub>b</sub>	D <sub>1</sub>
501-602-0026	26	278.6	263.40	80	150	25
501-602-0027	27	288.6	273.48	80	150	25
501-602-0028	28	298.7	283.56	80	150	25
501-602-0029	29	308.8	293.65	80	150	25
501-602-0030	30	318.9	303.75	80	150	25
501-602-0031	31	329.0	313.85	80	150	25
501-602-0032	32	339.1	323.91	80	150	25
501-602-0033	33	349.2	334.01	80	150	25
501-602-0034	34	359.3	344.10	80	150	25
501-602-0035	35	369.4	354.20	80	150	25
501-602-0036	36	379.5	364.30	80	150	30
501-602-0037	37	389.5	374.39	80	150	30
501-602-0038	38	399.6	384.49	80	150	30
501-602-0039	39	409.7	394.59	80	150	30
501-602-0040	40	419.8	404.66	80	150	30

### Rollenkette DIN 8187

20 B-2	Teilung	31,75mm
1 1/4" x 3/4"	Innere Breite	19,56mm
31,75 x 19,56mm	Rollen ø	19,05mm

### Kettenrad DIN 8196

Zahnbreite B1	18,5mm
Zahnbreite B2	54,6mm
ab Zähnezahl 18 mit geschweißter Nabe	
Werkstoff: C45	

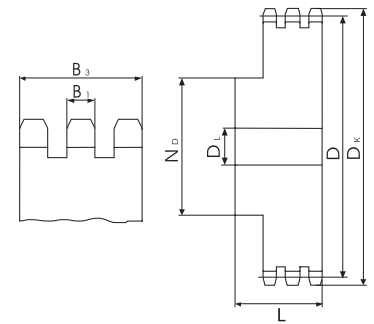

## Kettenräder – triplex

G&G-Best.-Nr.	Zz	D <sub>k</sub>	D	L	N <sub>b</sub>	D <sub>1</sub>
501-103-0008	8	28.0	24.89	32	15	6
501-103-0009	9	31.0	27.85	32	18	8
501-103-0010	10	34.0	30.82	32	20	10
501-103-0011	11	37.0	33.80	35	22	10
501-103-0012	12	40.0	36.80	35	25	10
501-103-0013	13	43.0	39.80	35	28	10
501-103-0014	14	46.3	42.80	35	31	12
501-103-0015	15	49.3	45.81	35	34	12
501-103-0016	16	52.3	48.82	35	37	12
501-103-0017	17	55.3	51.83	35	40	12
501-103-0018	18	58.3	54.85	35	43	12
501-103-0019	19	61.3	57.87	35	46	12
501-103-0020	20	64.3	60.89	35	49	12
501-103-0021	21	68.0	63.91	40	52	14
501-103-0022	22	71.0	66.93	40	55	14
501-103-0023	23	73.5	69.95	40	58	14
501-103-0024	24	77.0	72.97	40	61	14
501-103-0025	25	80.0	76.00	40	64	14

### Rollenkette DIN 8187

06 B-3  
3/8 x 7/32"  
9,525 x 5,72mm

Teilung 9,525mm  
Innere Breite 5,72mm  
Rollen ø 6,35mm

### Kettenrad DIN 8196

Zahnbreite B1 5,3mm  
Zahnbreite B3 25,6mm  
Werkstoff: C45

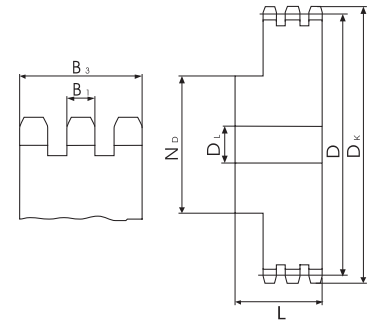

## Kettenräder – triplex

G&G-Best.-Nr.	Zz	D <sub>k</sub>	D	L	N <sub>b</sub>	D <sub>L</sub>
501-103-0026	26	83.0	79.02	40	67	14
501-103-0027	27	86.0	82.04	40	70	14
501-103-0028	28	89.0	85.07	40	73	14
501-103-0029	29	92.0	88.09	40	76	14
501-103-0030	30	94.7	91.12	40	79	14
501-103-0031	31	98.3	94.15	40	80	16
501-103-0032	32	101.3	97.17	40	80	16
501-103-0033	33	104.3	100.20	40	80	16
501-103-0034	34	107.3	103.23	40	85	16
501-103-0035	35	110.4	106.26	40	85	16
501-103-0036	36	113.4	109.29	40	90	16
501-103-0037	37	116.4	112.32	40	90	16
501-103-0038	38	119.5	115.34	40	90	16
501-103-0039	39	122.5	118.37	40	90	16
501-103-0040	40	125.5	121.40	40	90	16

### Rollenkette DIN 8187

06 B-3  
3/8 x 7/32"  
9,525 x 5,72mm

Teilung 9,525mm  
Innere Breite 5,72mm  
Rollen ø 6,35mm

### Kettenrad DIN 8196

Zahnbreite B1 5,3mm  
Zahnbreite B3 25,6mm  
Werkstoff: C45

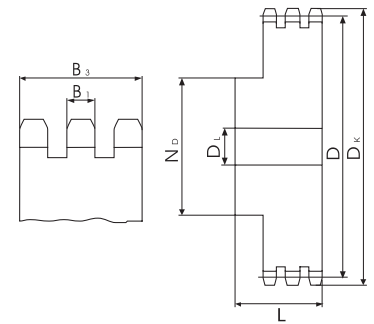

## Kettenräder – triplex

G&G-Best.-Nr.	Zz	D <sub>k</sub>	D	L	N <sub>b</sub>	D <sub>L</sub>
501-203-0008	8	37.20	33.18	46	20	10
501-203-0009	9	41.50	37.13	46	24	12
501-203-0010	10	46.20	41.10	46	28	12
501-203-0011	11	49.60	45.07	50	32	14
501-203-0012	12	53.90	49.07	50	35	14
501-203-0013	13	58.40	53.06	50	38	14
501-203-0014	14	62.80	57.07	50	42	14
501-203-0015	15	66.80	61.09	50	46	14
501-203-0016	16	70.90	65.10	50	50	16
501-203-0017	17	74.90	69.11	50	54	16
501-203-0018	18	78.90	73.14	50	58	16
501-203-0019	19	82.90	77.16	50	62	16
501-203-0020	20	86.90	81.19	50	66	16
501-203-0021	21	91.00	85.22	55	70	20
501-203-0022	22	95.00	89.24	55	70	20
501-203-0023	23	99.00	93.27	55	70	20
501-203-0024	24	103.00	97.29	55	75	20
501-203-0025	25	107.10	101.33	55	80	20

### Rollenkette DIN 8187

08 B-3  
1/2 x 5/16"  
12,7 x 7,75mm

Teilung 12,7mm  
Innere Breite 7,75mm  
Rollen ø 8,51mm

### Kettenrad DIN 8196

Zahnbreite B1 7,2mm  
Zahnbreite B3 34,9mm  
Werkstoff: C45

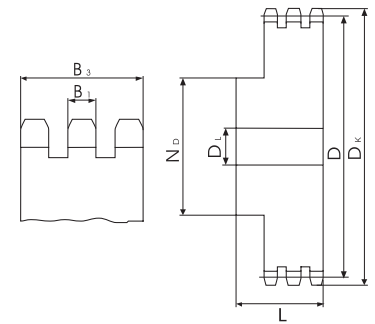

## Kettenräder – triplex

G&G-Best.-Nr.	Zz	D <sub>k</sub>	D	L	N <sub>b</sub>	D <sub>L</sub>
501-203-0026	26	111.20	105.36	55	85	20
501-203-0027	27	115.40	109.40	55	85	20
501-203-0028	28	119.40	113.42	55	90	20
501-203-0029	29	123.40	117.46	55	95	20
501-203-0030	30	127.50	121.50	55	100	20
501-203-0031	31	131.50	125.54	55	110	20
501-203-0032	32	135.50	129.56	55	110	20
501-203-0033	33	139.60	133.60	55	110	20
501-203-0034	34	143.60	137.64	55	110	20
501-203-0035	35	147.60	141.68	55	110	20
501-203-0036	36	151.70	145.72	55	120	25
501-203-0037	37	155.70	149.76	55	120	25
501-203-0038	38	159.80	153.80	55	120	25
501-203-0039	39	163.80	157.83	55	120	25
501-203-0040	40	167.80	161.87	55	120	25

### Rollenkette DIN 8187

08 B-3  
1/2 x 5/16"  
12,7 x 7,75mm

Teilung 12,7mm  
Innere Breite 7,75mm  
Rollen ø 8,51mm

### Kettenrad DIN 8196

Zahnbreite B1 7,2mm  
Zahnbreite B3 34,9mm  
Werkstoff: C45

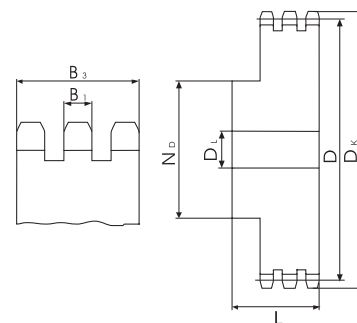

## Kettenräder – triplex

G&G-Best.-Nr.	Zz	D <sub>k</sub>	D	L	N <sub>b</sub>	D <sub>1</sub>
501-303-0008	8	47.0	41.48	55	25	12
501-303-0009	9	52.6	46.42	55	30	12
501-303-0010	10	57.5	51.37	55	35	16
501-303-0011	11	63.0	56.34	55	39	16
501-303-0012	12	68.0	61.34	55	44	16
501-303-0013	13	73.0	66.32	55	49	16
501-303-0014	14	78.0	71.34	55	54	16
501-303-0015	15	83.0	76.36	55	59	16
501-303-0016	16	88.0	81.37	60	64	16
501-303-0017	17	93.0	86.39	60	69	16
501-303-0018	18	98.3	91.42	60	74	16
501-303-0019	19	103.3	96.45	60	79	16
501-303-0020	20	108.4	101.49	60	84	16
501-303-0021	21	113.4	106.52	60	85	20
501-303-0022	22	118.0	111.55	60	90	20
501-303-0023	23	123.4	116.58	60	95	20
501-303-0024	24	128.3	121.62	60	100	20
501-303-0025	25	134.0	126.66	60	105	20

### Rollenkette DIN 8187

10 B-3  
5/8 x 3/8"  
15,875 x 9,65mm

Teilung 15,875mm  
Innere Breite 9,65mm  
Rollen ø 10,16mm

### Kettenrad DIN 8196

Zahnbreite B1 9,1mm  
Zahnbreite B3 42,1mm  
Werkstoff: C45

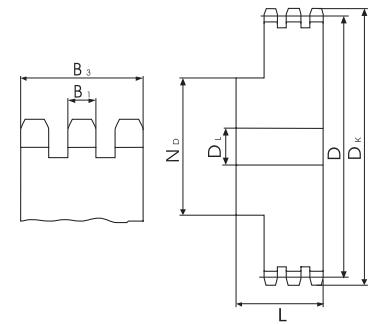

## Kettenräder – triplex

G&G-Best.-Nr.	Zz	D <sub>K</sub>	D	L	N <sub>b</sub>	D <sub>L</sub>
501-303-0026	26	139.0	131.70	60	110	20
501-303-0027	27	144.0	136.75	60	110	20
501-303-0028	28	148.7	141.78	60	115	20
501-303-0029	29	153.8	146.83	60	115	20
501-303-0030	30	158.8	151.87	60	120	20
501-303-0031	31	163.9	156.92	60	120	20
501-303-0032	32	168.9	161.95	60	120	20
501-303-0033	33	174.5	167.00	60	120	20
501-303-0034	34	179.0	172.05	60	120	20
501-303-0035	35	184.1	177.10	60	120	20
501-303-0036	36	189.1	182.15	60	120	25
501-303-0037	37	194.2	187.20	60	120	25
501-303-0038	38	199.2	192.24	60	120	25
501-303-0039	39	204.2	197.29	60	120	25
501-303-0040	40	209.3	202.34	60	120	25

### Rollenkette DIN 8187

10 B-3  
5/8 x 3/8"  
15,875 x 9,65mm

Teilung 15,875mm  
Innere Breite 9,65mm  
Rollen ø 10,16mm

### Kettenrad DIN 8196

Zahnbreite B1 9,1mm  
Zahnbreite B3 42,1mm  
Werkstoff: C45

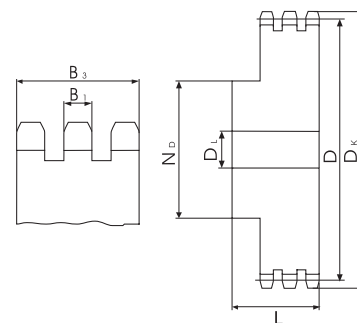

## Kettenräder – triplex

G&G-Best.-Nr.	Zz	D <sub>K</sub>	D	L	N <sub>b</sub>	D <sub>L</sub>
501-403-0008	8	57.6	49.78	65	31	16
501-403-0009	9	62.0	55.70	65	37	16
501-403-0010	10	69.0	61.64	65	42	16
501-403-0011	11	75.0	67.61	70	47	20
501-403-0012	12	81.5	73.60	70	53	20
501-403-0013	13	87.5	79.59	70	59	20
501-403-0014	14	93.6	85.61	70	65	20
501-403-0015	15	99.8	91.63	70	71	20
501-403-0016	16	105.5	97.65	70	77	20
501-403-0017	17	111.5	103.67	70	83	20
501-403-0018	18	118.0	109.71	70	89	20
501-403-0019	19	124.2	115.75	70	95	20
501-403-0020	20	129.7	121.78	70	100	20
501-403-0021	21	136.0	127.82	70	100	20
501-403-0022	22	141.8	133.86	70	100	20
501-403-0023	23	149.0	139.90	70	110	20
501-403-0024	24	153.9	145.94	70	110	20
501-403-0025	25	160.0	152.00	70	120	20

### Rollenkette DIN 8187

12 B-3  
3/4 x 7/16"  
19,05 x 11.68mm

Teilung 19,05mm  
Innere Breite 11,68mm  
Rollen ø 12,07mm

### Kettenrad DIN 8196

Zahnbreite B1 11,1mm  
Zahnbreite B3 49,8mm  
Werkstoff: C45



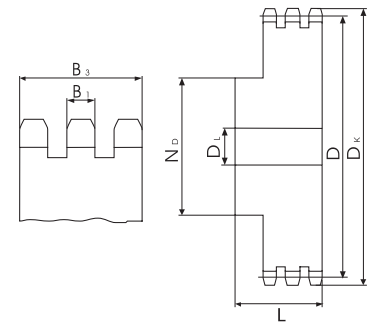

## Kettenräder – triplex

G&G-Best.-Nr.	Zz	D <sub>k</sub>	D	L	N <sub>b</sub>	D <sub>L</sub>
501-403-0026	26	165.9	158.04	70	120	20
501-403-0027	27	172.3	164.09	70	120	20
501-403-0028	28	178.0	170.13	70	120	20
501-403-0029	29	184.1	176.19	70	120	20
501-403-0030	30	190.5	182.25	70	120	20
501-403-0031	31	196.3	188.31	70	130	25
501-403-0032	32	203.3	194.35	70	130	25
501-403-0033	33	209.3	200.40	70	130	25
501-403-0034	34	214.6	206.46	70	130	25
501-403-0035	35	221.0	212.52	70	130	25
501-403-0036	36	226.8	218.58	70	130	25
501-403-0037	37	232.9	224.64	70	130	25
501-403-0038	38	239.0	230.69	70	130	25
501-403-0039	39	245.1	236.75	70	130	25
501-403-0040	40	251.3	242.81	70	130	25

### Rollenkette DIN 8187

12 B-3	Teilung	19,05mm
3/4 x 7/16"	Innere Breite	11,68mm
19,05 x 11.68mm	Rollen ø	12,07mm

### Kettenrad DIN 8196

Zahnbreite B1	11,1mm
Zahnbreite B3	49,8mm
Werkstoff:	C45

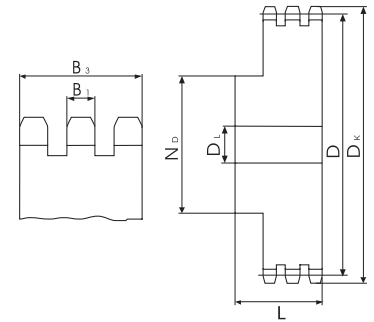

## Kettenräder – triplex

G&G-Best.-Nr.	Zz	D <sub>k</sub>	D	L	N <sub>b</sub>	D <sub>L</sub>
501-503-0008	8	77.0	66.37	95	42	20
501-503-0009	9	85.0	74.27	95	50	20
501-503-0010	10	93.0	82.19	95	56	20
501-503-0011	11	99.5	90.14	100	64	25
501-503-0012	12	109.0	98.14	100	72	25
501-503-0013	13	117.0	106.12	100	80	25
501-503-0014	14	125.0	114.15	100	88	25
501-503-0015	15	133.0	122.17	100	96	25
501-503-0016	16	141.0	130.20	100	104	30
501-503-0017	17	149.0	138.22	100	112	30
501-503-0018	18	157.0	146.28	100	120	30
501-503-0019	19	165.2	154.33	100	128	30
501-503-0020	20	173.2	162.38	100	130	30
501-503-0021	21	181.2	170.43	100	130	30
501-503-0022	22	189.3	178.48	100	130	30
501-503-0023	23	197.5	186.53	100	130	30
501-503-0024	24	205.5	194.59	100	130	30
501-503-0025	25	213.5	202.66	100	130	30

### Rollenkette DIN 8187

16 B-3	Teilung	25,40mm
1" x 17,02mm	Innere Breite	17,02mm
25,4 x 17,02mm	Rollen ø	15,88mm

### Kettenrad DIN 8196

Zahnbreite B1	16,2mm
Zahnbreite B3	79,6mm
ab Zähnezahl 21 mit geschweißter Nabe	
Werkstoff: C45	

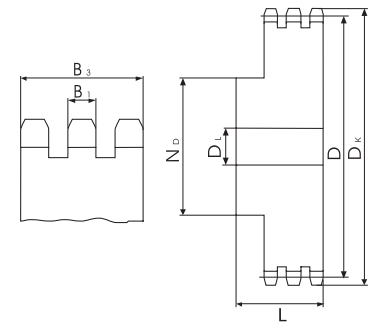

## Kettenräder – triplex

G&G-Best.-Nr.	Zz	D <sub>k</sub>	D	L	N <sub>b</sub>	D <sub>L</sub>
501-503-0026	26	221.6	210.72	100	130	30
501-503-0027	27	229.6	218.79	100	130	30
501-503-0028	28	237.7	226.85	100	130	30
501-503-0029	29	245.8	234.92	100	130	30
501-503-0030	30	254.0	243.00	100	130	30
501-503-0031	31	262.0	251.08	100	140	30
501-503-0032	32	270.0	259.13	100	140	30
501-503-0033	33	278.5	267.21	100	140	30
501-503-0034	34	287.0	275.28	100	140	30
501-503-0035	35	296.2	283.36	100	140	30
501-503-0036	36	304.6	291.44	100	140	30
501-503-0037	37	312.6	299.51	100	140	30
501-503-0038	38	320.7	307.59	100	140	30
501-503-0039	39	328.8	315.67	100	140	30
501-503-0040	40	336.9	323.73	100	140	30

### Rollenkette DIN 8187

16 B-3	Teilung	25,40mm
1" x 17,02mm	Innere Breite	17,02mm
25,4 x 17,02mm	Rollen ø	15,88mm

### Kettenrad DIN 8196

Zahnbreite B1	16,2mm
Zahnbreite B3	79,6mm
ab Zähnezahl 21 mit geschweißter Nabe	
Werkstoff: C45	

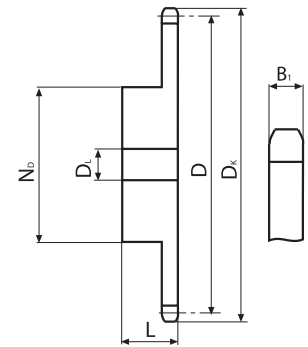

## Kettenräder gehärtet – simplex

G&G-Best.-Nr.	Zz	D <sub>K</sub>	D	L	N <sub>b</sub>	D <sub>L</sub>
501-101-0412	12	40.0	36.80	25	25	8
501-101-0413	13	43.0	39.80	25	28	10
501-101-0414	14	46.3	42.80	25	31	10
501-101-0415	15	49.3	45.81	25	34	10
501-101-0416	16	52.3	48.82	28	37	10
501-101-0417	17	55.3	51.83	28	40	10
501-101-0418	18	58.3	54.85	28	43	10
501-101-0419	19	61.3	57.87	28	45	10
501-101-0420	20	64.3	60.89	28	46	10
501-101-0421	21	68.0	63.91	28	48	12
501-101-0422	22	71.0	66.93	28	50	12
501-101-0423	23	74.0	69.95	28	52	12
501-101-0424	24	77.0	72.97	28	54	12
501-101-0425	25	80.0	76.00	28	57	12
501-101-0430	30	94.7	91.12	28	60	12

### Rollenkette DIN 8187

06 B-1  
3/8 x 7/32"  
9,525 x 5,72mm

Teilung 9,525mm  
Innere Breite 5,72mm  
Rollen ø 6,35mm

### Kettenrad DIN 8196

Zahnbreite B1 5,3mm  
Werkstoff: C45 – gehärtet

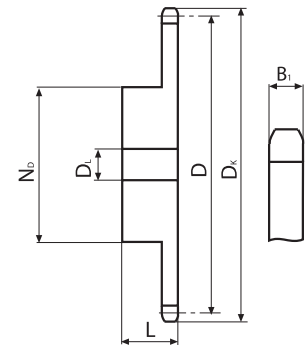

## Kettenräder gehärtet – simplex

G&G-Best.-Nr.	Zz	D <sub>K</sub>	D	L	N <sub>b</sub>	D <sub>L</sub>
501-201-0412	12	53.90	49.07	28	33	10
501-201-0413	13	58.40	53.06	28	37	10
501-201-0414	14	62.80	57.07	28	41	10
501-201-0415	15	66.80	61.09	28	45	10
501-201-0416	16	70.90	65.10	28	50	12
501-201-0417	17	74.90	69.11	28	52	12
501-201-0418	18	78.90	73.14	28	56	12
501-201-0419	19	82.90	77.16	28	60	12
501-201-0420	20	86.90	81.19	28	64	12
501-201-0421	21	91.00	85.22	28	68	12
501-201-0422	22	95.00	89.24	28	70	12
501-201-0423	23	99.00	93.27	28	70	14
501-201-0424	24	103.00	97.29	28	70	14
501-201-0425	25	107.10	101.33	28	70	14
501-201-0430	30	127.50	121.50	90	80	16

### Rollenkette DIN 8187

08 B-1  
1/2 x 5/16"  
12,7 x 7,75mm

Teilung 12,7mm  
Innere Breite 7,75mm  
Rollen ø 8,51mm

### Kettenrad DIN 8196

Zahnbreite B1 7,2mm  
Werkstoff: C45 – gehärtet

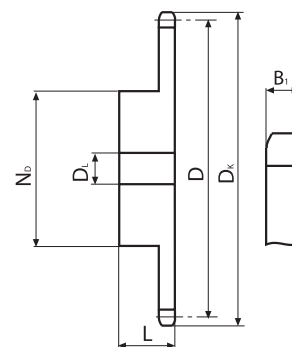

## Kettenräder gehärtet – simplex

G&G-Best.-Nr.	Zz	D <sub>K</sub>	D	L	N <sub>b</sub>	D <sub>L</sub>
501-301-0412	12	68.0	61.34	30	42	12
501-301-0413	13	73.0	66.32	30	47	12
501-301-0414	14	78.0	71.34	30	52	12
501-301-0415	15	83.0	76.36	30	57	12
501-301-0416	16	88.0	81.37	30	60	12
501-301-0417	17	93.0	86.39	30	60	12
501-301-0418	18	98.3	91.42	30	70	14
501-301-0419	19	103.3	96.45	30	70	14
501-301-0420	20	108.4	101.49	30	75	14
501-301-0421	21	113.4	106.52	30	75	16
501-301-0422	22	118.0	111.55	30	80	16
501-301-0423	23	123.4	116.58	30	80	16
501-301-0424	24	128.3	121.62	30	80	16
501-301-0425	25	134.0	126.66	30	80	16
501-301-0430	30	158.8	151.17	35	90	20

### Rollenkette DIN 8187

10 B-1  
5/8 x 3/8"  
15,875 x 9,65mm

Teilung 15,875mm  
Innere Breite 9,65mm  
Rollen ø 10,16mm

### Kettenrad DIN 8196

Zahnbreite B1 9,1mm  
Werkstoff: C45 – gehärtet

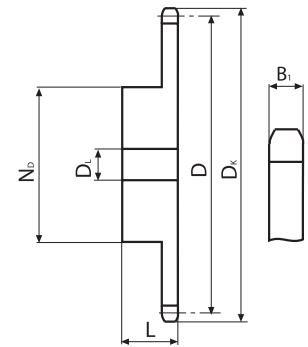

## Kettenräder gehärtet – simplex

G&G-Best.-Nr.	Zz	D <sub>K</sub>	D	L	N <sub>b</sub>	D <sub>L</sub>
501-401-0412	12	81.5	73.60	35	52	14
501-401-0413	13	87.5	79.59	35	58	14
501-401-0414	14	93.6	85.61	35	64	14
501-401-0415	15	99.8	91.63	35	70	14
501-401-0416	16	105.5	97.65	35	75	16
501-401-0417	17	111.5	103.67	35	80	16
501-401-0418	18	118.0	109.71	35	80	16
501-401-0419	19	124.2	115.75	35	80	16
501-401-0420	20	129.7	121.78	35	80	16
501-401-0421	21	136.0	127.82	40	90	20
501-401-0422	22	141.8	133.86	40	90	20
501-401-0423	23	149.0	139.90	40	90	20
501-401-0424	24	153.9	145.94	40	90	20
501-401-0425	25	160.0	152.00	40	90	20
501-401-0430	30	190.5	182.25	40	95	20

### Rollenkette DIN 8187

12 B-1	Teilung	19,05mm
3/4 x 7/16"	Innere Breite	11,68mm
19,05 x 11,68mm	Rollen ø	12,07mm

### Kettenrad DIN 8196

Zahnbreite B1	11,1mm
Werkstoff: C45 – gehärtet	

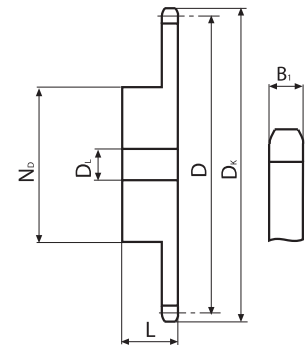

## Kettenräder gehärtet – simplex

G&G-Best.-Nr.	Zz	D <sub>K</sub>	D	L	N <sub>b</sub>	D <sub>1</sub>
501-501-0412	12	109.0	98.14	40	69	16
501-501-0413	13	117.0	106.12	40	78	16
501-501-0414	14	125.0	114.15	40	84	16
501-501-0415	15	133.0	122.17	40	92	16
501-501-0416	16	141.0	130.20	45	100	20
501-501-0417	17	149.0	138.22	45	100	20
501-501-0418	18	157.0	146.28	45	100	20
501-501-0419	19	165.2	154.33	45	100	20
501-501-0420	20	173.2	162.38	45	100	20
501-501-0421	21	181.2	170.43	50	110	20
501-501-0422	22	189.3	178.48	50	110	20
501-501-0423	23	197.5	186.53	50	110	20
501-501-0424	24	205.5	194.59	50	110	20
501-501-0425	25	213.5	202.66	50	110	20
501-501-0430	30	254.0	243.00	50	120	20

### Rollenkette DIN 8187

16 B-1	Teilung	25,40mm
1" x 17,02mm	Innere Breite	17,02mm
25,4 x 17,02mm	Rollen ø	15,88mm

### Kettenrad DIN 8196

Zahnbreite B1	16,2mm
Werkstoff: C45 – gehärtet	



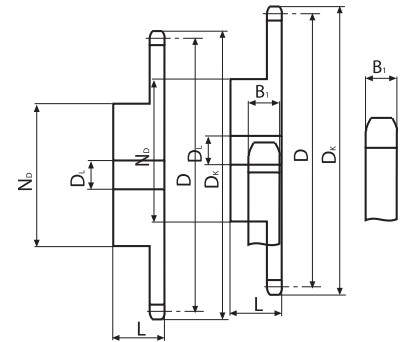

## Kettenräder rostfrei – simplex

G&G-Best.-Nr.	Zz	D <sub>K</sub>	D	L	N <sub>b</sub>	D <sub>L</sub>
501-101-0612	12	40.0	36.80	25	25	8
501-101-0613	13	43.0	39.80	25	28	10
501-101-0614	14	46.3	42.80	25	31	10
501-101-0615	15	49.3	45.81	25	34	10
501-101-0616	16	52.3	48.82	28	37	10
501-101-0617	17	55.3	51.83	28	40	10
501-101-0618	18	58.3	54.85	28	43	10
501-101-0619	19	61.3	57.87	28	45	10
501-101-0620	20	64.3	60.89	28	46	10
501-101-0621	21	68.0	63.91	28	48	12
501-101-0622	22	71.0	66.93	28	50	12
501-101-0623	23	74.0	69.95	28	52	12
501-101-0624	24	77.0	72.97	28	54	12
501-101-0625	25	80.0	76.00	28	57	12
501-101-0630	30	94.7	91.12	28	60	12

### Rollenkette DIN 8187

06 B-1  
3/8 x 7/32"  
9,525 x 5,72mm

Teilung 9,525mm  
Innere Breite 5,72mm  
Rollen ø 6,35mm

### Kettenrad DIN 8196

Zahnbreite B1 5,3mm  
Werkstoff: 1.4301

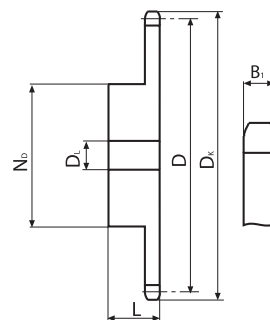

## Kettenräder rostfrei – simplex

G&G-Best.-Nr.	Zz	D <sub>K</sub>	D	L	N <sub>b</sub>	D <sub>L</sub>
501-201-0612	12	53.9	49.07	28	33	10
501-201-0613	13	58.4	53.06	28	37	10
501-201-0614	14	62.8	57.07	28	41	10
501-201-0615	15	66.8	61.09	28	45	10
501-201-0616	16	70.9	65.10	28	50	12
501-201-0617	17	74.9	69.11	28	52	12
501-201-0618	18	78.9	73.14	28	56	12
501-201-0619	19	82.9	77.16	28	60	12
501-201-0620	20	86.9	81.19	28	64	12
501-201-0621	21	91.0	85.22	28	68	12
501-201-0622	22	95.0	89.24	28	70	12
501-201-0623	23	99.0	93.27	28	70	14
501-201-0624	24	103.0	97.29	28	70	14
501-201-0625	25	107.1	101.33	28	70	14
501-201-0626	26	111.2	105.36	30	70	16
501-201-0630	30	127.5	121.50	30	80	16

### Rollenkette DIN 8187

08 B-1  
1/2 x 5/16"  
12,7 x 7,75mm

Teilung 12,7mm  
Innere Breite 7,75mm  
Rollen ø 8,51mm

### Kettenrad DIN 8196

Zahnbreite B1 7,2mm  
Werkstoff: 1.4301

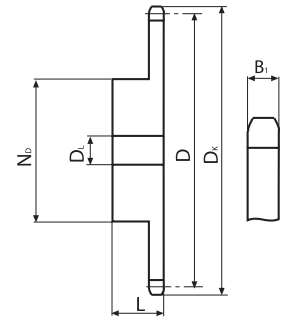

## Kettenräder rostfrei – simplex

G&G-Best.-Nr.	Zz	D <sub>K</sub>	D	L	N <sub>b</sub>	D <sub>L</sub>
501-301-0611	11	63.0	56.34	30	37	12
501-301-0612	12	68.0	61.34	30	42	12
501-301-0613	13	73.0	66.32	30	47	12
501-301-0614	14	78.0	71.34	30	52	12
501-301-0615	15	83.0	76.36	30	57	12
501-301-0616	16	88.0	81.37	30	60	12
501-301-0617	17	93.0	86.39	30	60	12
501-301-0618	18	98.3	91.42	30	70	14
501-301-0619	19	103.3	96.45	30	70	14
501-301-0620	20	108.4	101.49	30	75	14
501-301-0621	21	113.4	106.52	30	75	16
501-301-0622	22	118.0	111.55	30	80	16
501-301-0623	23	123.4	116.58	30	80	16
501-301-0624	24	128.3	121.62	30	80	16
501-301-0625	25	134.0	126.66	30	80	16
501-301-0630	30	158.8	151.87	35	90	20

### Rollenkette DIN 8187

10 B-1  
5/8 x 3/8"  
15,875 x 9,65mm

Teilung 15,875mm  
Innere Breite 9,65mm  
Rollen ø 10,16mm

### Kettenrad DIN 8196

Zahnbreite B1 9,1mm  
Werkstoff: 1.4301

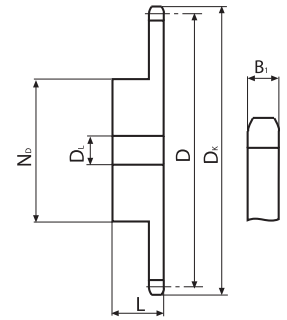

## Kettenräder rostfrei – simplex

G&G-Best.-Nr.	Zz	D <sub>K</sub>	D	L	N <sub>b</sub>	D <sub>L</sub>
501-401-0611	11	75.0	67.61	35	46	14
501-401-0612	12	81.5	73.60	35	52	14
501-401-0613	13	87.5	79.59	35	58	14
501-401-0614	14	93.6	85.61	35	64	14
501-401-0615	15	99.8	91.63	35	70	14
501-401-0616	16	105.5	97.65	35	75	16
501-401-0617	17	111.5	103.67	35	80	16
501-401-0618	18	118.0	109.71	35	80	16
501-401-0619	19	124.2	115.75	35	80	16
501-401-0620	20	129.7	121.78	35	80	16
501-401-0621	21	136.0	127.82	40	90	20
501-401-0622	22	141.8	133.86	40	90	20
501-401-0623	23	149.0	139.90	40	90	20
501-401-0624	24	153.9	145.94	40	90	20
501-401-0625	25	160.0	152.00	40	90	20
501-401-0630	30	190.5	182.25	40	95	20

### Rollenkette DIN 8187

12 B-1	Teilung	19,05mm
3/4 x 7/16"	Innere Breite	11,68mm
19,05 x 11,68mm	Rollen ø	12,07mm

### Kettenrad DIN 8196

Zahnbreite B1	11,1mm
Werkstoff: 1.4301	

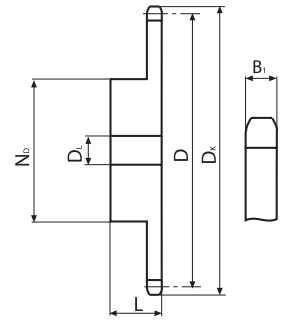

## Kettenräder rostfrei – simplex

G&G-Best.-Nr.	Zz	D <sub>K</sub>	D	L	N <sub>b</sub>	D <sub>L</sub>
501-501-0613	13	117.0	106.12	40	78	16
501-501-0614	14	125.0	114.15	40	84	16
501-501-0615	15	133.0	122.17	40	92	16
501-501-0616	16	141.0	130.20	45	100	20
501-501-0617	17	149.0	138.22	45	100	20
501-501-0618	18	157.0	146.28	45	100	20
501-501-0619	19	165.2	154.33	45	100	20
501-501-0620	20	173.2	162.38	45	100	20
501-501-0621	21	181.2	170.43	50	110	20
501-501-0622	22	189.3	178.48	50	110	20
501-501-0623	23	197.5	186.53	50	110	20
501-501-0624	24	205.5	194.59	50	110	20
501-501-0625	25	213.5	202.66	50	110	20
501-501-0630	30	254.0	243.00	50	120	20

### Rollenkette DIN 8187

16 B-1  
1" x 17,02mm  
25,4 x 17,02mm

Teilung 25,4mm  
Innere Breite 17,02mm  
Rollen ø 15,88mm

### Kettenrad DIN 8196

Zahnbreite B1 16,2mm  
Werkstoff: 1.4301

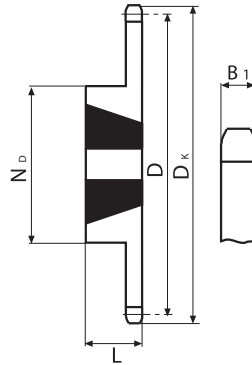

## Kettenräder für Klemmbuchsen – simplex

G&G-Best.-Nr.	Zz	D <sub>k</sub>	D	L	N <sub>D</sub>	Klemmbuchse
501-101-0517	17	55.3	51.83	22	45	120-010-08XX
501-101-0518	18	58.3	54.85	22	45	120-010-08XX
501-101-0519	19	61.3	57.87	22	45	120-010-08XX
501-101-0520	20	64.3	60.89	22	46	120-010-08XX
501-101-0521	21	68.0	63.91	22	46	120-010-08XX
501-101-0522	22	71.0	66.93	22	50	120-010-08XX
501-101-0523	23	73.5	69.95	25	63	120-012-10XX
501-101-0524	24	77.0	72.97	25	63	120-012-10XX
501-101-0525	25	80.0	76.00	25	63	120-012-10XX
501-101-0526	26	83.0	79.02	25	63	120-012-10XX
501-101-0527	27	86.0	82.04	25	63	120-012-10XX
501-101-0528	28	89.0	85.07	25	63	120-012-10XX
501-101-0530	30	94.7	91.12	25	63	120-012-10XX
501-101-0538	38	119.5	115.35	25	70	120-012-10XX
501-101-0545	45	140.7	136.55	25	70	120-012-10XX
501-101-0557	57	176.9	172.91	25	70	120-012-10XX
501-101-0576	76	234.9	230.49	25	70	120-012-10XX

### Rollenkette DIN 8187

06 B-1  
3/8 x 7/32"  
9,525 x 5,72

Teilung 9,525mm  
Innere Breite 5,72mm  
Rollen ø 6,35mm

### Kettenrad

Zahnbreite B1 5,3mm  
Werkstoff: C45  
Werkstoff: Guss (ab Zähnezahl 45)

## Klemmbuchsen

G&G-Best.-Nr.	Bohrung (XX)
120-010-08XX	ø 10/11/14/15/16/18/19/20/22/24/25
120-012-10XX	ø 12/14/15/16/18/19/20/22/24/25/26/28/30/32

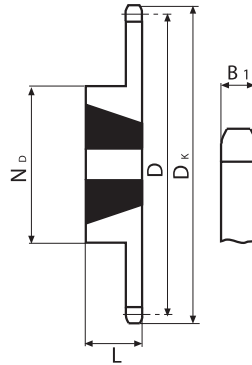

## Kettenräder für Klemmbuchsen – simplex

G&G-Best.-Nr.	Zz	D <sub>k</sub>	D	L	N <sub>D</sub>	Klemmbuchse
501-201-0514	14	62.8	57.07	22	45	120-010-08XX
501-201-0515	15	66.8	61.09	22	50	120-010-08XX
501-201-0516	16	70.9	65.10	25	50	120-012-10XX
501-201-0517	17	74.9	69.11	25	60	120-012-10XX
501-201-0518	18	78.9	73.14	25	63	120-012-10XX
501-201-0519	19	82.9	77.16	25	71	120-012-10XX
501-201-0520	20	86.9	81.19	25	71	120-016-10XX
501-201-0521	21	91.0	85.22	25	71	120-016-10XX
501-201-0522	22	95.0	89.24	25	76	120-016-10XX
501-201-0523	23	99.0	93.27	25	76	120-016-10XX
501-201-0524	24	103.0	97.29	25	76	120-016-10XX
501-201-0525	25	107.1	101.33	25	76	120-016-10XX
501-201-0526	26	111.2	105.36	25	76	120-016-10XX
501-201-0527	27	115.4	109.40	25	76	120-016-10XX
501-201-0528	28	119.4	113.42	32	90	120-020-12XX
501-201-0530	30	127.5	121.50	32	90	120-020-12XX
501-201-0538	38	158.6	153.80	32	90	120-020-12XX
501-201-0545	45	188.0	182.07	32	100	120-020-12XX
501-201-0557	57	236.4	230.54	32	100	120-020-12XX
501-201-0576	76	313.3	307.33	32	100	120-020-12XX

### Rollenkette DIN 8187

08 B-1  
1/2 x 5/16"  
12,7 x 7,75mm

Teilung 12,7mm  
Innere Breite 7,75mm  
Rollen ø 8,51mm

### Kettenrad

Zahnbreite B1 7,2mm  
Werkstoff: C45  
Werkstoff: Guss (ab Zähnezahl 45)

## Klemmbuchsen

G&G-Best.-Nr.	Bohrung (XX)
120-010-08XX	ø 10/11/14/15/16/18/19/20/22/24/25
120-012-10XX	ø 12/14/15/16/18/19/20/22/24/25/26/28/30/32
120-016-10XX	ø 12/14/15/16/18/19/20/22/24/25/26/28/30/32/35/38/40/42
120-020-12XX	ø 16/18/19/20/22/24/25/26/28/30/32/35/38/40/42/45/48/50

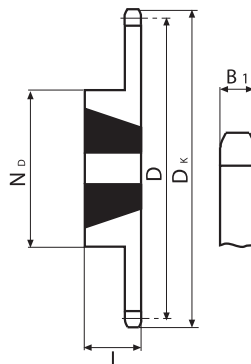

## Kettenräder für Klemmbuchsen – simplex

G&G-Best.-Nr.	Zz	D <sub>k</sub>	D	L	N <sub>D</sub>	Klemmbuchse
501-301-0513	13	73.0	66.32	22	47	120-010-08XX
501-301-0514	14	78.0	71.34	22	52	120-011-08XX
501-301-0515	15	83.0	76.36	25	60	120-012-10XX
501-301-0516	16	88.0	81.37	25	70	120-016-10XX
501-301-0517	17	93.0	86.39	25	71	120-016-10XX
501-301-0518	18	98.3	91.42	25	75	120-016-10XX
501-301-0519	19	103.3	96.45	25	75	120-016-10XX
501-301-0520	20	108.4	101.49	25	75	120-016-10XX
501-301-0521	21	113.4	106.52	25	76	120-016-10XX
501-301-0522	22	118.0	111.55	25	76	120-016-10XX
501-301-0523	23	123.4	116.58	25	76	120-016-10XX
501-301-0524	24	128.3	121.62	32	90	120-016-10XX
501-301-0525	25	134.0	126.66	32	90	120-020-12XX
501-301-0526	26	139.0	131.70	32	90	120-020-12XX
501-301-0527	27	144.0	136.75	32	90	120-020-12XX
501-301-0528	28	148.7	141.78	32	90	120-020-12XX
501-301-0530	30	158.8	151.87	32	90	120-020-12XX
501-301-0538	38	199.2	192.24	32	100	120-020-12XX
501-301-0545	45	235.0	227.58	32	100	120-020-12XX
501-301-0557	57	296.0	288.18	32	100	120-020-12XX
501-301-0576	76	392.1	384.16	32	100	120-020-12XX

### Rollenkette DIN 8187

10 B-1  
5/8 x 3/8"  
15,875 x 9,65mm

Teilung 15,875mm  
Innere Breite 9,65mm  
Rollen ø 10,16mm

### Kettenrad

Zahnbreite B<sub>1</sub> 9,10mm  
Werkstoff: C45  
Werkstoff: Guss (ab Zähnezahl 45)

## Klemmbuchsen

G&G-Best.-Nr.	Bohrung (XX)
120-010-08XX	ø 10/11/14/15/16/18/19/20/22/24/25
120-012-10XX	ø 12/14/15/16/18/19/20/22/24/25/26/28/30/32
120-016-10XX	ø 12/14/15/16/18/19/20/22/24/25/26/28/30/32/35/38/40/42
120-020-12XX	ø 16/18/19/20/22/24/25/26/28/30/32/35/38/40/42/45/48/50



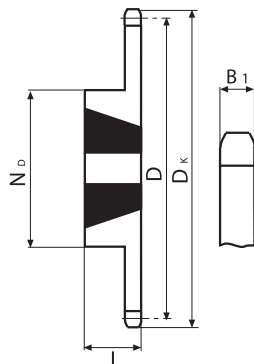

## Kettenräder für Klemmbuchsen – simplex

G&G-Best.-Nr.	Zz	D <sub>k</sub>	D	L	N <sub>D</sub>	Klemmbuchsen
501-401-0513	13	87.5	79.59	25	60	120-012-10XX
501-401-0514	14	93.6	85.61	25	70	120-016-10XX
501-401-0515	15	99.8	91.63	25	70	120-016-10XX
501-401-0516	16	105.5	97.65	25	75	120-016-10XX
501-401-0517	17	111.5	103.67	25	76	120-016-10XX
501-401-0518	18	118.0	109.71	32	90	120-020-12XX
501-401-0519	19	124.2	115.75	32	90	120-020-12XX
501-401-0520	20	129.7	121.78	32	90	120-020-12XX
501-401-0521	21	136.0	127.82	45	102	120-025-17XX
501-401-0522	22	141.8	133.86	45	102	120-025-17XX
501-401-0523	23	149.0	139.90	45	108	120-025-17XX
501-401-0524	24	153.9	145.94	45	108	120-025-17XX
501-401-0525	25	160.0	152.00	45	108	120-025-17XX
501-401-0526	26	165.9	158.04	45	108	120-025-17XX
501-401-0527	27	172.3	164.09	45	108	120-025-17XX
501-401-0528	28	178.0	170.13	45	108	120-025-17XX
501-401-0530	30	190.5	182.25	45	108	120-025-17XX
501-401-0538	38	239.0	230.69	45	108	120-025-17XX
501-401-0545	45	282.5	273.10	45	108	120-025-17XX
501-401-0557	57	355.4	345.81	45	108	120-025-17XX
501-401-0576	76	469.9	460.99	45	108	120-025-17XX
501-401-0595	95	585.1	576.17	45	108	120-025-17XX

### Rollenkette DIN 8187

12 B-1  
3/4 x 7/16"  
19,05 x 11,68mm

Teilung 19,05mm  
Innere Breite 11,68mm  
Rollen ø 12,07mm

### Kettenrad

Zahnbreite B<sub>1</sub> 11,10mm  
Werkstoff: C45  
Werkstoff: Guss (ab Zähnezahl 45)

## Klemmbuchsen

G&G-Best.-Nr.	Bohrung (XX)
120-012-10XX	ø 12/14/15/16/18/19/20/22/24/25/26/28/30/32
120-016-10XX	ø 12/14/15/16/18/19/20/22/24/25/26/28/30/32/35/38/40/42
120-020-12XX	ø 16/18/19/20/22/24/25/26/28/30/32/35/38/40/42/45/48/50
120-025-17XX	ø 18/19/20/22/24/25/26/28/30/32/35/38/40/42/45/48/50/55/60/65

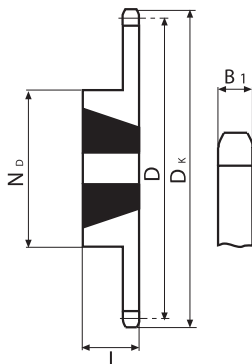

## Kettenräder für Klemmbuchsen – simplex

G&G-Best.-Nr.	Zz	D <sub>k</sub>	D	L	N <sub>D</sub>	Klemmbuchse
501-501-0513	13	117.0	106.12	25	73	120-016-10XX
501-501-0514	14	125.0	114.15	25	76	120-016-10XX
501-501-0515	15	133.0	122.17	25	76	120-016-10XX
501-501-0516	16	141.0	130.20	32	90	120-020-12XX
501-501-0517	17	149.0	138.22	32	90	120-020-12XX
501-501-0518	18	157.0	146.28	45	108	120-025-17XX
501-501-0519	19	165.2	154.33	45	108	120-025-17XX
501-501-0520	20	173.2	162.38	45	108	120-025-17XX
501-501-0521	21	181.2	170.43	45	110	120-025-17XX
501-501-0522	22	189.3	178.48	45	110	120-025-17XX
501-501-0523	23	197.5	186.53	45	110	120-025-17XX
501-501-0524	24	205.5	194.59	45	110	120-025-17XX
501-501-0525	25	213.5	202.66	45	110	120-025-17XX
501-501-0526	26	221.6	210.72	45	110	120-025-17XX
501-501-0527	27	229.6	218.79	45	110	120-025-17XX
501-501-0528	28	237.7	226.85	45	110	120-025-17XX
501-501-0530	30	254.0	243.00	51	140	120-030-20XX
501-501-0538	38	320.7	307.59	51	140	120-030-20XX
501-501-0545	45	377.1	364.13	51	140	120-030-20XX
501-501-0557	57	474.0	461.07	51	140	120-030-20XX
501-501-0576	76	627.0	614.65	51	140	120-030-20XX
501-501-0595	95	781.1	768.22	51	140	120-030-20XX

### Rollenkette DIN 8187

16 B-1  
1" x 17,02mm  
25,4 x 17,02mm

Teilung 25,4mm  
Innere Breite 17,02mm  
Rollen ø 15,88mm

### Kettenrad

Zahnbreite B<sub>1</sub> 16,2mm  
Werkstoff: C45  
Werkstoff: Guss (ab Zähnezahl 57)

## Klemmbuchsen

G&G-Best.-Nr.	Bohrung (XX)
120-016-10XX	ø 12/14/15/16/18/19/20/22/24/25/26/28/30/32/35/38/40/42
120-020-12XX	ø 16/18/19/20/22/24/25/26/28/30/32/35/38/40/42/45/48/50
120-025-17XX	ø 18/19/20/22/24/25/26/28/30/32/35/38/40/42/45/48/50/55/60/65
120-030-20XX	ø 25/28/30/32/35/38/40/42/45/48/50/55/60/65/70/75

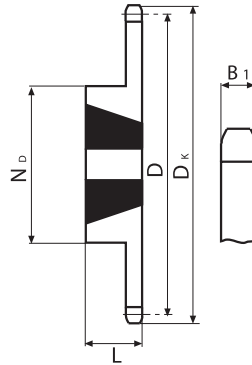

## Kettenräder für Klemmbuchsen – simplex

G&G-Best.-Nr.	Zz	D <sub>k</sub>	D	L	N <sub>D</sub>	Klemmbuchse
501-601-0515	15	167.9	152.72	45	108	120-025-17XX
501-601-0517	17	187.9	172.78	45	108	120-025-17XX
501-601-0519	19	208.1	192.91	45	108	120-025-17XX
501-601-0521	21	228.2	213.04	45	108	120-025-17XX
501-601-0523	23	248.3	233.17	45	108	120-025-17XX
501-601-0525	25	268.5	253.33	45	108	120-025-17XX
501-601-0530	30	318.9	303.75	51	150	120-030-20XX
501-601-0538	38	399.6	384.49	51	160	120-030-20XX
501-601-0545	45	470.3	455.17	51	160	120-030-20XX
501-601-0557	57	591.5	576.39	51	160	120-030-20XX
501-601-0576	76	783.5	768.32	51	160	120-030-20XX

### Rollenkette DIN 8187

20 B-1	Teilung	31,75mm
1 1/4 x 3/4"	Innere Breite	19,56mm
31,75 x 19,56mm	Rollen ø	19,05mm

### Kettenrad

Zahnbreite B1	18,50mm
Werkstoff: C45	
Werkstoff: Guss (ab Zähnezahl 38)	

## Klemmbuchsen

G&G-Best.-Nr.	Bohrung (XX)
120-025-17XX	ø 18/19/20/22/24/25/26/28/30/32/35/38/40/42/45/48/50/55/60/65
120-030-20XX	ø 25/28/30/32/35/38/40/42/45/48/50/55/60/65/70/75

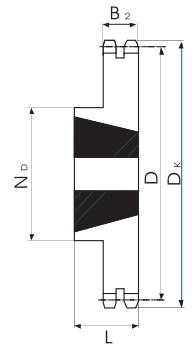

## Kettenräder für Klemmbuchsen – duplex

G&G-Best.-Nr.	Zz	D <sub>k</sub>	D	L	N <sub>b</sub>	Klemmbuchse
501-102-0517	17	55.3	51.83	22	42	120-010-08XX
501-102-0518	18	58.3	54.85	22	43	120-010-08XX
501-102-0519	19	61.3	57.87	22	46	120-010-08XX
501-102-0520	20	64.3	60.89	22	48	120-010-08XX
501-102-0521	21	68.0	63.91	22	49	120-010-08XX
501-102-0522	22	71.0	66.93	22	52	120-011-08XX
501-102-0523	23	73.5	69.95	25	59	120-012-10XX
501-102-0524	24	77.0	72.97	25	61	120-012-10XX
501-102-0525	25	80.0	76.00	25	64	120-012-10XX
501-102-0526	26	83.0	79.02	25	65	120-012-10XX
501-102-0527	27	86.0	82.04	25	70	120-012-10XX
501-102-0528	28	89.0	85.07	25	70	120-012-10XX
501-102-0530	30	94.7	91.12	25	75	120-012-10XX
501-102-0538	38	119.5	115.35	25	80	120-016-10XX
501-102-0545	45	140.7	136.55	25	80	120-016-10XX
501-102-0557	57	176.9	172.91	25	80	120-016-10XX
501-102-0576	76	234.9	230.49	25	80	120-016-10XX
501-102-0595	95	292.5	288.08	25	90	120-016-10XX

### Rollenkette DIN 8187

06 B-2  
3/8 x 7/32"  
9,525 x 5,72mm

Teilung 9,525mm  
Innere Breite 5,72mm  
Rollen ø 6,35mm

### Kettenrad

Zahnbreite B2 15,4mm  
Werkstoff: C45  
Werkstoff: Guss (ab Zähnezahl 45)

## Klemmbuchsen

G&G-Best.-Nr.	Bohrung (XX)
120-010-08XX	ø 10/11/14/15/16/18/19/20/22/24/25
120-011-08XX	ø 11/12/14/15/16/17/18/19/20/22/24/25/26/28
120-012-10XX	ø 12/14/15/16/18/19/20/22/24/25/26/28/30/32
120-016-10XX	ø 12/14/15/16/18/19/20/22/24/25/26/28/30/32/35/38/40/42

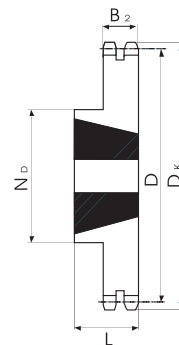

## Kettenräder für Klemmbuchsen – duplex

G&G-Best.-Nr.	Zz	D <sub>k</sub>	D	L	N <sub>b</sub>	Klemmbuchse
501-202-0515	15	66.8	61.09	22	46	120-010-08XX
501-202-0517	17	74.9	69.11	22	56	120-012-10XX
501-202-0519	19	82.9	77.16	25	62	120-012-10XX
501-202-0520	20	86.9	81.19	25	66	120-016-10XX
501-202-0521	21	91.0	85.22	25	70	120-016-10XX
501-202-0522	22	95.0	89.24	25	76	120-016-10XX
501-202-0523	23	99.0	93.27	25	79	120-016-10XX
501-202-0525	25	107.1	101.33	32	87	120-020-12XX
501-202-0526	26	111.2	105.36	32	87	120-020-12XX
501-202-0527	27	115.4	109.40	32	87	120-020-12XX
501-202-0530	30	127.5	121.50	32	87	120-020-12XX
501-202-0538	38	158.6	153.80	32	100	120-020-12XX
501-202-0545	45	188.0	182.07	32	100	120-020-12XX
501-202-0557	57	236.4	230.54	32	100	120-020-12XX
501-202-0576	76	313.3	307.33	32	100	120-020-12XX
501-202-0595	95	390.1	384.11	32	100	120-020-12XX

### Rollenkette DIN 8187

08 B-2  
1/2 x 5/16"  
12,7 x 7,75mm

Teilung 12,7mm  
Innere Breite 7,75mm  
Rollen ø 8,51mm

### Kettenrad

Zahnbreite B2 21,0mm  
Werkstoff: C45  
Werkstoff: Guss (ab Zähnezahl 45)

## Klemmbuchsen

G&G-Best.-Nr.	Bohrung (XX)
120-010-08XX	ø 10/11/14/15/16/18/19/20/22/24/25
120-012-10XX	ø 12/14/15/16/18/19/20/22/24/25/26/28/30/32
120-016-10XX	ø 12/14/15/16/18/19/20/22/24/25/26/28/30/32/35/38/40/42
120-020-12XX	ø 16/18/19/20/22/24/25/26/28/30/32/35/38/40/42/45/48/50

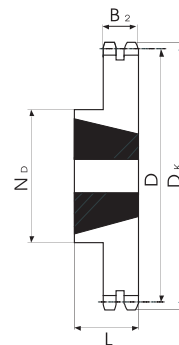

## Kettenräder für Klemmbuchsen – duplex

G&G-Best.-Nr.	Zz	D <sub>k</sub>	D	L	N <sub>D</sub>	Klemmbuchse
501-302-0515	15	83.0	76.36	25.5	-	120-012-10XX
501-302-0517	17	93.0	86.39	25.5	-	120-016-10XX
501-302-0519	19	103.3	96.45	25.5	-	120-016-10XX
501-302-0520	20	108.4	101.49	25.5	-	120-016-10XX
501-302-0521	21	113.4	106.52	25.5	-	120-016-10XX
501-302-0522	22	118.0	111.55	25.5	-	120-016-10XX
501-302-0523	23	123.4	116.58	25.5	-	120-016-10XX
501-302-0525	25	134.0	126.66	32	90	120-020-12XX
501-302-0527	27	144.0	136.75	32	90	120-020-12XX
501-302-0530	30	158.8	151.87	32	90	120-020-12XX
501-302-0538	38	199.2	192.24	32	108	120-025-17XX

### Rollenkette DIN 8187

10 B-2  
5/8 x 3/8"  
15,875 x 9,65mm

Teilung 15,875mm  
Innere Breite 9,65mm  
Rollen ø 10,16mm

### Kettenrad

Zahnbreite B2 25,5mm  
bis Zähnezahl 23 – Ausführung als Scheibe  
Werkstoff: C45

## Klemmbuchsen

G&G-Best.-Nr.	Bohrung (XX)
120-012-10XX	ø 12/14/15/16/18/19/20/22/24/25/26/28/30/32
120-016-10XX	ø 12/14/15/16/18/19/20/22/24/25/26/28/30/32/35/38/40/42
120-020-12XX	ø 16/18/19/20/22/24/25/26/28/30/32/35/38/40/42/45/48/50
120-025-17XX	ø 18/19/20/22/24/25/26/28/30/32/35/38/40/42/45/48/50/55/60/65

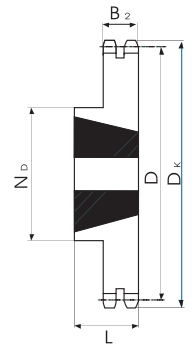

## Kettenräder für Klemmbuchsen – duplex

G&G-Best.-Nr.	Zz	D <sub>k</sub>	D	L	N <sub>D</sub>	Klemmbuchsen
501-402-0515	15	99.8	91.63	30.3	-	120-016-10XX
501-402-0516	16	105.5	97.65	30.3	-	120-016-10XX
501-402-0517	17	111.5	103.67	30.3	-	120-016-10XX
501-402-0518	18	118.0	109.71	32	90	120-020-12XX
501-402-0519	19	124.2	115.75	32	90	120-020-12XX
501-402-0520	20	129.7	121.78	45	108	120-025-17XX
501-402-0521	21	136.0	127.82	45	108	120-025-17XX
501-402-0522	22	141.8	133.86	45	108	120-025-17XX
501-402-0523	23	149.0	139.90	45	108	120-025-17XX
501-402-0524	24	153.9	145.94	45	108	120-025-17XX
501-402-0525	25	160.0	152.00	45	108	120-025-17XX
501-402-0526	26	165.9	158.04	45	108	120-025-17XX
501-402-0527	27	172.3	164.09	45	108	120-025-17XX
501-402-0528	28	178.0	170.13	45	108	120-025-17XX
501-402-0530	30	190.5	182.25	45	108	120-025-17XX
501-402-0538	38	239.0	230.69	51	140	120-030-20XX
501-402-0545	45	282.5	273.10	51	140	120-030-20XX
501-402-0557	57	355.4	345.81	51	140	120-030-20XX
501-402-0576	76	469.9	460.99	51	140	120-030-20XX
501-402-0595	95	585.1	576.17	76	140	120-030-20XX

### Rollenkette DIN 8187

12 B-2	Teilung	19,05mm
3/4 x 7/16"	Innere Breite	11,68mm
19,05 x 11,68mm	Rollen ø	12,07mm

### Kettenrad

Zahnbreite B2	30,3mm
bis Zähnezahl 17 – Ausführung als Scheibe	
Werkstoff: C45	
Werkstoff: Guss (ab Zähnezahl 45)	

## Klemmbuchsen

G&G-Best.-Nr.	Bohrung (XX)
120-016-10XX	ø 12/14/15/16/18/19/20/22/24/25/26/28/30/32/35/38/40/42
120-020-12XX	ø 16/18/19/20/22/24/25/26/28/30/32/35/38/40/42/45/48/50
120-025-17XX	ø 18/19/20/22/24/25/26/28/30/32/35/38/40/42/45/48/50/55/60/65
120-030-20XX	ø 25/28/30/32/35/38/40/42/45/48/50/55/60/65/70/75

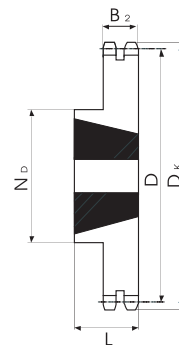

## Kettenräder für Klemmbuchsen – duplex

G&G-Best.-Nr.	Zz	D <sub>k</sub>	D	L	N <sub>D</sub>	Klemmbuchsen
501-502-0515	15	133.0	122.17	47.7	-	120-020-12XX
501-502-0517	17	149.0	138.22	47.7	-	120-025-17XX
501-502-0519	19	165.2	154.33	47.7	-	120-025-17XX
501-502-0521	21	181.2	170.43	51	140	120-030-20XX
501-502-0523	23	197.5	186.53	51	140	120-030-20XX
501-502-0525	25	213.5	202.66	51	140	120-030-20XX
501-502-0527	27	229.6	218.79	51	140	120-030-20XX
501-502-0530	30	254.0	243.00	51	140	120-030-20XX
501-502-0538	38	320.7	307.59	51	140	120-030-20XX
501-502-0545	45	377.1	364.13	51	140	120-030-20XX
501-502-0557	57	474.0	461.07	65	175	120-035-35XX
501-502-0576	76	627.0	614.65	65	175	120-035-35XX
501-502-0595	95	781.1	768.22	102	215	120-035-35XX

### Rollenkette DIN 8187

16 B-2  
1" x 17,02mm  
25,4 x 17,02mm

Teilung 25,4mm  
Innere Breite 17,02mm  
Rollen ø 15,88mm

### Kettenrad

Zahnbreite B2 47,7mm  
bis Zähnezahl 20 – Ausführung als Scheibe  
Werkstoff: C45  
Werkstoff: Guss (ab Zähnezahl 45)

## Klemmbuchsen

G&G-Best.-Nr.	Bohrung (XX)
120-020-12XX	ø 16/18/19/20/22/24/25/26/28/30/32/35/38/40/42/45/48/50
120-025-17XX	ø 18/19/20/22/24/25/26/28/30/32/35/38/40/42/45/48/50/55/60/65
120-030-20XX	ø 25/28/30/32/35/38/40/42/45/48/50/55/60/65/70/75
120-035-35XX	ø 45/48/50/55/60/65/70/75/80/85/90